

# CONTENTS

<b>Warranty Details</b>	<b>2</b>	<b>Mercedes Benz</b>	<b>45</b>
<b>Catalogue Information</b>	<b>3</b>	<b>Mitsubishi Jeep</b>	<b>46</b>
<b>Alfa Romeo</b>	<b>4</b>	<b>MG</b>	<b>47</b>
<b>Aston Martin</b>	<b>6</b>	<b>Morris</b>	<b>49</b>
<b>Austin Healey</b>	<b>7</b>	<b>Morgan</b>	<b>50</b>
<b>Bentley-Rolls Royce</b>	<b>8</b>	<b>Nissan</b>	<b>51</b>
<b>BMC</b>	<b>9</b>	<b>Oldsmobile</b>	<b>53</b>
<b>BMW</b>	<b>10</b>	<b>Plymouth</b>	<b>54</b>
<b>Buick</b>	<b>10</b>	<b>Pontiac</b>	<b>55</b>
<b>Cadillac</b>	<b>11</b>	<b>Porsche</b>	<b>56</b>
<b>Chev</b>	<b>12</b>	<b>Rambler</b>	<b>57</b>
<b>Chrysler</b>	<b>17</b>	<b>Renault</b>	<b>58</b>
<b>Crusader Marine</b>	<b>19</b>	<b>Riley</b>	<b>59</b>
<b>Desoto</b>	<b>19</b>	<b>Rover &amp; Landrover</b>	<b>60</b>
<b>Chrysler/Dodge/Plymou</b>	<b>20</b>	<b>Saab</b>	<b>61</b>
<b>Daimler</b>	<b>21</b>	<b>Singer</b>	<b>62</b>
<b>Ferrari</b>	<b>22</b>	<b>Standard</b>	<b>63</b>
<b>Fiat</b>	<b>22</b>	<b>Sunbeam Talbot</b>	<b>64</b>
<b>Ford</b>	<b>24</b>	<b>Subaru</b>	<b>64</b>
<b>Harley Davidson</b>	<b>30</b>	<b>Talbot</b>	<b>64</b>
<b>Hillman</b>	<b>31</b>	<b>Toyota</b>	<b>65</b>
<b>Holden</b>	<b>32</b>	<b>Triumph</b>	<b>66</b>
<b>International-Petrol</b>	<b>34</b>	<b>Vauxhall</b>	<b>68</b>
<b>Jaguar</b>	<b>35</b>	<b>Volkswagen</b>	<b>69</b>
<b>Jensen</b>	<b>38</b>	<b>Wolseley</b>	<b>70</b>
<b>Lada</b>	<b>39</b>	<b>Parts &amp; Accessories</b>	<b>71</b>
<b>Lancia</b>	<b>40</b>	<b>Wiper Motor Kits</b>	<b>72</b>
<b>Leyland</b>	<b>41</b>	<b>Wiper Accessories</b>	<b>76</b>
<b>Lotus</b>	<b>42</b>	<b>Dynogen</b>	<b>77</b>
<b>Mazda</b>	<b>43</b>	<b>Alternators &amp; Generators</b>	<b>78</b>
<b>Maserati</b>	<b>44</b>	<b>Ignition Systems</b>	<b>79</b>

update: 15/11/2016

# WARRANTY

The manufacturers warranty on Hi-Torque products is for a period of one (1) year, covering the Starter Motor ONLY. The warranty is subject to the following conditions.

- \* All claims must be made within the warranty period.
- \* Any Starter Motors found to have faulty workmanship will be replaced free of charge.
- \* This warranty does not apply to Starter Motors that have been subject to neglect, misuse, abuse, accidental or intentional damage, unauthorized repairs, modifications, incorrect application or installation. \*Please check description below.
- \* Hi-Torque recommend that this product be fitted by qualified technician.
- \* The warranty does not cover the cost of freight, installation or removal of Starter Motor.
- \* The warranty only applies to Starter Motors used for normal road use.

\*Starter motors that have been misused or abused include the following: Water damage, Over heated, Pinion engaged while driving or hi revving and Extreme dust or corrosive conditions.  
It's up to the purchaser/installer to ensure the starter motor is sealed or protected if used for Off Road or Marine applications.

## **ORDERING**

Orders can be placed by phone, fax or email. We prefer official purchase orders from account customers. Please quote the part number, quantity and any special requirements when ordering.

## **SHIPPING**

All orders are despatched upon payment (except account customers). We ship Australia-wide everyday. We can do C.O.D using Australia Post (conditions apply). If you wish to use you own courier, please advise us your account details and courier name and we can organise pick-up.

## **PAYMENT**

can be made by credit card (Visa, MasterCard and Bankcard only), direct deposit, cheque/money order or cash over the counter. Please note that cheques and money orders must include the full amount of the order and freight costs.

## **RETURN OF GOODS**

All parts returned will incur a 20% re-stocking fee. Returns must be made within 30 Days. Freight is to be paid by customer unless the goods are being returned due to manufacturing defect or shipping error, in which case they are to be shipped using our Australia Post Reply Paid account. C.O.D. post will NOT be accepted under any circumstances. Goods specifically made to customers requests cannot be returned for credit. All goods remain the property of Castle Automotive Enterprises until paid for in full.

## **DAMAGE**

All goods are shipped in good condition and are packed accordingly. We can only handle damage claims for prepaid freight.

# STARTER INFORMATION

How to measure and calculate the Starter Specifications.

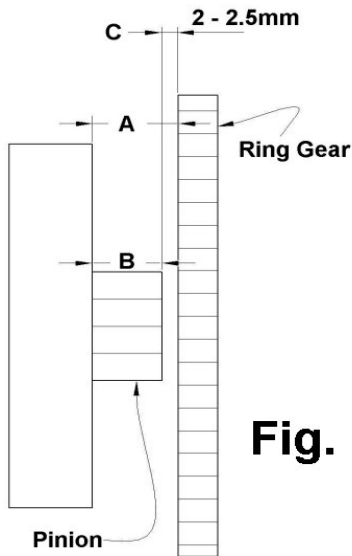

**Fig. 1**

## Spigot Diameter

This is the diameter of the the spigot that locates the starter on the bell housing, engine etc as example shown in Fig 2 below.

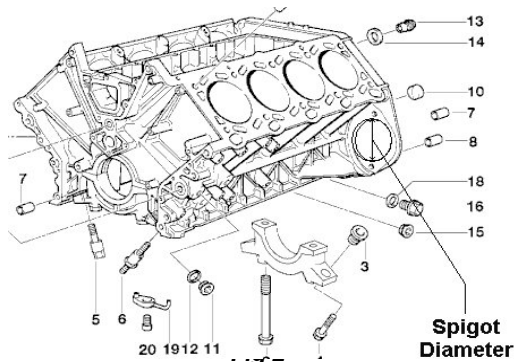

## Rotating End Blocks

Almost all Hi-Torque Gear Reduction starters feature rotational end blocks. This gives the customer the ability to rotate the starter body to obtain the correct clearance. This is done simply by removing the two screws that hold the aluminium block on the starter body, then rotate the starter body and replacing the screws.

## Pinion at Rest

Correct pinion & ring gear clearance is needed before starting the engine. If this is not correct, damage will occur. With the starter motor disengaged and mounted correctly, the pinion to ring gear clearance (Outer of mesh) should be 2 to 2.5mm See figure 1

Before fitting the Starter measured from the Contact Edge of Drive Plates Ring Gear to the Front Edge of the Starter Pinion in stationary Position. See Fig. 1

To Calculate the Outer of Mesh measure the distance from the Starter mounting face to the front side of the ring gear. (A) Then measure the Starter mounting face to the end of the pinion. (B) The difference between measurement (A) and (B) is the Outer of Mesh clearance (C)

$$A..... - B..... = C$$

If this is less than 2mm then the shim spacers will be needed. Shims are available on

## Operating Voltage

Operating Voltage is the specified voltage the starter is designed for. This will be either 12 Volts or 24 Volts.

**WARNING USING A 12V STARTER ON 24V SYSTEM WILL DAMAGE THE STARTER AND VOID THE WARRANTY.**

12v starter can run reliably using a 16v Battery.



For Customer fitting instructions please check our website at

[www.caenterprises.com.au/documents.php](http://www.caenterprises.com.au/documents.php)

# ALFA ROMEO

## 105 Series 1964-74

G/R-05

130 tooth Ring Gear

Teeth	Diameter	Rest	C/C		Rating	Diameter	Diameter
9	25mm	10mm	3 Hole 56.5mm	12	1.9hp	62mm	8.5mm

Replaces Bosch 0 001 311 110

## 105 Series

G/R-05/GTV

1969-72 all 1750cc Engines with 132 tooth ring gear.

Pinion Teeth	Pinion Diameter	Pinion at Rest	Mt. holes C/C	Voltage	Power Rating	Spigot Diameter	Mt. holes Diameter
8	27mm	9mm	3 Hole 56.5mm	12	1.9hp	62mm	8.5mm

Replaces Bosch 9 000 062 000 & 001 211 016

## 105 Series

G/R-05/2ltr

2Ltr Engine with 132 Tooth Ring Gear

Pinion Teeth	Pinion Diameter	Pinion at Rest	Mt. holes C/C	Voltage	Power Rating	Spigot Diameter	Mt. holes Diameter
8	27mm	10mm	3 Hole 56.5mm	12	1.9hp	62mm	8.5mm

Replaces Bosch 0 004 211 004 & 0 001 211 987.

## 3.2 Lt V6

G/R-05/V6

GTV-V-75 and 90 Series

Pinion Teeth	Pinion Diameter	Pinion at Rest	Mt. holes C/C	Voltage	Power Rating	Spigot Diameter	Mt. holes Diameter
9	25mm	6mm	2 Hole 105mm	12	1.9hp	62mm	11mm

Replaces Bosch 0 001311139

# ALFA ROMEO

## 33 Series

G/R-05/33-8v

Boxer Engine 8 Valve 1991-1995

Pinion Teeth	Pinion Diameter	Pinion at Rest	Mt. holes C/C	Voltage	Power Rating	Spigot Diameter	Mt. holes Diameter
9	25mm	27mm	2 Hole 105mm	12	1.9hp	76mm	10.5mm

- Replaces Bosch 0.001-211-215

## 33 Series

G/R-05/33-16v

Boxer Engine 16 Valve 1991-1995

Pinion Teeth	Pinion Diameter	Pinion at Rest	Mt. holes C/C	Voltage	Power Rating	Spigot Diameter	Mt. holes Diameter
9	25mm	27mm	2 Hole 105mm	12	1.9hp	76mm	10.5mm

- Sample Starter Motor required

# ALFETTA

## 116 Series - 1972-1986

G/R-05/Alfetta

Pinion Teeth	Pinion Diameter	Pinion at Rest	Mt. holes C/C	Voltage	Power Rating	Spigot Diameter	Mt. holes Diameter
9	25mm	10mm	3 Hole 56.5	12	1.9hp	62mm	9mm

- Replaces B-0001311181

Note: Uses 131 Tooth ring gear  
Drive is offset

# ASTON MARTIN

**DB2-DB6 1955-70**

**G/R-7**

Pinion Teeth	Pinion Diameter	Pinion at Rest	Mt. holes C/C	Voltage	Power Rating	Spigot Diameter	Mt. holes Diameter
10	40mm	28mm	146mm	12	1.9hp	92mm	11mm

- Replaces Lucas M45G 26034B
- 2 hole mount (replaces original 3 hole mount)

# AUSTIN HEALEY

## Healey 3000

G/R-06

100-6cyl, 100-4cyl.

Pinion Teeth	Pinion Diameter	Pinion at Rest	Mt. holes C/C	Voltage	Power Rating	Spigot Diameter	Mt. holes Diameter
10	40mm	21mm	2 hole 127mm	12	1.9hp	88.8mm	3/8" UNC

- Replaces Lucas M418G-25521-D
- Ferguson Tractor 25083H
- Replaces Lucas M45G-26183F 2M100-25668B/D

## Healey Sprite 1275cc

G/R-06/SP

Replaces 418G-25541E, 25526A, 25511D

Pinion Teeth	Pinion Diameter	Pinion at Rest	Mt. holes C/C	Voltage	Power Rating	Spigot Diameter	Mt. holes Diameter
10	29mm	28mm	2 Hole 127mm	12	1.9hp	88.8mm	11mm

## Austin/Morris 1800cc

G/R-06/1800

Pinion Teeth	Pinion Diameter	Pinion at Rest	Mt. holes C/C	Voltage	Power Rating	Spigot Diameter	Mt. holes Diameter
9	29mm	22mm	2 Hole	12	1.9hp	88.8mm	11mm or
10	29mm		127mm				3/8" UNC

## Austin/Morris Maxi, & A60 Cambridge

G/R-09

Use G/R-09

Pinion Teeth	Pinion Diameter	Pinion at Rest	Mt. holes C/C	Voltage	Power Rating	Spigot Diameter	Mt. holes Diameter
10	29mm	27mm	2 Hole 114mm	12	1.9hp	88mm	11mm

## Austin A30, A35, A40, A50, A55 & Freeway 1959-62

G/R-23/LUCAS-M35G

Replaces Lucas M35G 25022A/D and M35G25006A

Pinion Teeth	Pinion Diameter	Pinion at Rest	Mt. holes C/C	Voltage	Power Rating	Spigot Diameter	Mt. holes Diameter
9	29mm	28mm	2 Hole 127mm	12	1.9hp	88.8mm	11mm

# BENTLEY-ROLLS ROYCE

## Silver Shadow

G/R-8

### Rolls Royce Silver Shadow V8

Also suits Silver Spirit 6.75ltr

Pinion Teeth	Pinion Diameter	Pinion at Rest	Mt. holes C/C	Voltage	Power Rating	Spigot Diameter	Mt. holes Diameter
11	29mm	32mm	3 Hole 127mm SAE	12	2.5hp	88.8mm	10.5mm

- Silver Spirit - Replaces Lucas 27458 2M113

\* NOTE: 11Tooth pinion replaces original 9Tooth x 25mm dia

## Bentley S1, S6 and R6 1968

G/R-8/S6 & R6

Pinion Teeth	Pinion Diameter	Pinion at Rest	Mt. holes C/C	Voltage	Power Rating	Spigot Diameter	Mt. holes Diameter
14	49.75mm	26/22mm*	N/A	12	2.5hp	N/A	N/A

- Replaces Lucas M45G 26120
- Pinion at rest is taken from centre of locating dowel to end of pinion
- Check distance from centre of locating dowel pin hole to face of ring gear

## Rolls Royce Silver Cloud V8

G/R-8/SC

Pinion Teeth	Pinion Diameter	Pinion at Rest	Mt. holes C/C	Voltage	Power Rating	Spigot Diameter	Mt. holes Diameter
11	29mm	55mm	3 Hole 127mm SAE	12	2.5hp	88.8mm	10.5mm

- Replaces Lucas M45 26175E

\* NOTE: 11Tooth pinion replaces original 9Tooth x 25mm dia



# BMC

---

**Mini** with no Oil Cooler

**G/R-9**

850, 1000, 1100, 1275 & Cooper S, Mini Moke, Austin & Morris

Pinion Teeth	Pinion Diameter	Pinion at Rest	Mt. holes C/C	Voltage	Power Rating	Spigot Diameter	Mt. holes Diameter
10	29mm	27mm	114mm 2 Hole	12	1.9hp	88mm	11mm

• Replaces Lucas 25075B, 25147, 67201A, 62925007, 62925008, 25083J

---

**Mini** with Oil Cooler

**G/R-9A**

850, 1000, 1100, 1275 & Cooper S, Mini Moke, Austin & Morris

Pinion Teeth	Pinion Diameter	Pinion at Rest	Mt. holes C/C	Voltage	Power Rating	Spigot Diameter	Mt. holes Diameter
10	29mm	27mm	114mm 2 Hole	12	1.9hp	88mm	11mm

• Replaces Lucas 25075B, 25147, 67201A, 62925007, 62925008, 25083J

# BMW

**BMW 4cyl 2300**

**G/R-56**

Pinion Teeth	Pinion Diameter	Pinion at Rest	Mt. holes C/C	Voltage	Power Rating	Spigot Diameter	Mt. holes Diameter
9	29mm	28	2 Hole 105	12	1.4kW	76	11

# Buick

**1937-1940**

**G/R-47**

Pinion Teeth	Pinion Diameter	Pinion at Rest	Mt. holes C/C	Voltage	Power Rating	Spigot Diameter	Mt. holes Diameter
9	29mm	39	2 Hole 105	12	2.0Kw	82	11mm

**455Cu. In.**

**G/R-47/455**

*Replaces the Original Delco unit.*

Pinion Teeth	Pinion Diameter	Pinion at Rest	Mt. holes C/C	Voltage	Power Rating	Spigot Diameter	Mt. holes Diameter
9	25	22mm	Block 2 Hole 83mm	12	2.0Kw	NA	10mm

**455Cu. In.**

**G/R-47/455A**

*Replaces the Original Delco 1107355 B12*

Pinion Teeth	Pinion Diameter	Pinion at Rest	Mt. holes C/C	Voltage	Power Rating	Spigot Diameter	Mt. holes Diameter
9	25	32mm	offset 2 Hole Flange 102mm	12	2	76mm	10mm

**264Cu. In. V8 Engine (Nail Head)**

**G/R-47/264**

*Replaces the Original Delco unit.*

Pinion Teeth	Pinion Diameter	Pinion at Rest	Mt. holes C/C	Voltage	Power Rating	Spigot Diameter	Mt. holes Diameter
9	25mm	41mm	2 Hole 105mm	12	1.4Kw	82.4mm	13mm

# Cadillac

---

## 1956 to 1961 Cadillac 390 and 356 Ci V8 Engines

**G/R-48**

Pinion Teeth	Pinion Diameter	Pinion at Rest	Mt. holes C/C	Voltage	Power Rating	Spigot Diameter	Mt. holes Diameter
9	25mm	22mm	2 Hole 104mm	12	2.0Kw	82	7/16 unc

- Replaces Original Delco P/N 1107273

---

## 1961 to 1963 Cadillac 390 Ci V8 Engines

**G/R-48A**

Pinion Teeth	Pinion Diameter	Pinion at Rest	Mt. holes C/C	Voltage	Power Rating	Spigot Diameter	Mt. holes Diameter
9	25mm	26mm	2 Hole 104mm	12	2.0Kw	84mm	7/16 unc

- Replaces Original Delco P/N 1107799 & 1107311

# CHEVROLET

## Small Block & Big Block

G/R-01/1.9  
G/R-01/2.5  
G/R-01/3.0

Pinion Teeth	Pinion Diameter	Pinion at Rest	Mt. holes C/C	Voltage	Power Rating	Spigot Diameter	Mt. holes Diameter
11	29mm	11mm	2 Hole 83mm*	12	1.9/2.5hp	N/A	10mm

- Suits 153 & 168 tooth ring gear. Dual inline bolt pattern
- NOTE: 11Tooth pinion replaces original 9Tooth x 25mm dia

## Small Block & Big Block

G/R-01/2.5 x 11"-168Tooth

Staggered Bolt Pattern

Pinion Teeth	Pinion Diameter	Pinion at Rest	Mt. holes C/C	Voltage	Power Rating	Spigot Diameter	Mt. holes Diameter
11	29mm	11mm	2 Hole 83.85mm	12	2.5hp	N/A	10mm

- Only suits 168 tooth ring gear/11" clutch with staggered bolt pattern.
- Replaces Ashdowns DXS-501
- NOTE: 11Tooth pinion replaces original 9Tooth x 25mm dia

## Small Block

G/R-01/LHS/SB

Left Hand Side Mount. Replaces Oil Filter

Pinion Teeth	Pinion Diameter	Pinion at Rest	Mt. holes C/C	Voltage	Power Rating	Spigot Diameter	Mt. holes Diameter
9	25mm	11mm	2 Hole 83mm	12	1.9hp	N/A	10mm

- Only suits 168 tooth ring gear.
- Includes provision for remote oil filter lines
- Must be used with remote oil filter

## Small Block

G/R-01/LHSM

Left Hand Side. Mount Only

Pinion Teeth	Pinion Diameter	Pinion at Rest	Mt. holes C/C	Voltage	Power Rating	Spigot Diameter	Mt. holes Diameter
N/A	N/A	N/A	2 Hole 83mm	N/A	N/A	N/A	10mm

- Mount only. Starter motor not included
- Only suits 168 tooth ring gear.
- Suit Nippon Denso & Hitachi starter motors

## BIG Block

G/R-01/LHS/BB

Left Hand Side Mount. Replaces Oil Filter

Pinion Teeth	Pinion Diameter	Pinion at Rest	Mt. holes C/C	Voltage	Power Rating	Spigot Diameter	Mt. holes Diameter
11	29mm	11mm	2 Hole 83mm	12	1.9hp	N/A	10mm

# CHEVROLET

## Small Block & Big Block

G/R-01/142T

Racing Application. Left Hand Side Mount. 142T Ring Gear

Pinion Teeth	Pinion Diameter	Pinion at Rest	Mt. holes C/C	Voltage	Power Rating	Spigot Diameter	Mt. holes Diameter
9	25mm	11mm	2 Hole 83mm	12	1.9hp	N/A	10mm

- Designed for racing applications where starter mounts on LHS
- Can only be used with 142 tooth ring gear
- Will suit Dart Small Blocks & Dart Big Blocks

## Small Block & Big Block

G/R-01/24v

24v

Pinion Teeth	Pinion Diameter	Pinion at Rest	Mt. holes C/C	Voltage	Power Rating	Spigot Diameter	Mt. holes Diameter
11	29mm	11mm	2 Hole 83mm	24	3.5hp	N/A	10mm

- Suits 153 & 168 tooth ring gear. Dual inline bolt pattern
- \* **NOTE: 11Tooth pinion replaces original 9Tooth x 25mm dia**

## Small Block

G/R-01/COM

Fitted to Commodore VB-VC-VH-VK-VL

Pinion Teeth	Pinion Diameter	Pinion at Rest	Mt. holes C/C	Voltage	Power Rating	Spigot Diameter	Mt. holes Diameter
9	25mm	11mm	2 Hole 83mm	12	1.9hp	N/A	

- Designed for Holden Commodore fitted with Chev Small Block
- Can only be used with non-power steering applications. For power steering app. use G/R-01/LHS
- Suits 153 & 168 tooth ring gear. Dual inline bolt pattern

## Small Block & Big Block

G/R-01/3CCW

Counter Clockwise Direction

Pinion Teeth	Pinion Diameter	Pinion at Rest	Mt. holes C/C	Voltage	Power Rating	Spigot Diameter	Mt. holes Diameter
11	29mm	11mm	2 Hole 83mm*	12	1.9/2.5hp	N/A	10mm

- Suits Speedboat reverse mounted engine and adapter Bell housing
- Suits 153 & 168 tooth ring gear. Dual inline bolt pattern
- NOTE: 11Tooth pinion replaces original 9Tooth x 25mm dia

# CHEVROLET

## Small Block & Big Block

**G/R-01/CHEV**

Pinion Teeth	Pinion Diameter	Pinion at Rest	Mt. holes C/C	Voltage	Power Rating	Spigot Diameter	Mt. holes Diameter
10	28mm	11mm	2 Hole 83mm*	12	1.9hp	N/A	1.9hp

- **Smallest Chev Starter available**

Also available in Chrome Finish

**G/R-01/CHEV CHROME**

- Ideal for applications where space is limited
- Suits 153 & 168 tooth ring gear. Dual inline bolt pattern
- 360° rotation on end block

## Small Block & Big Block

**SH-2202**

Pinion Teeth	Pinion Diameter	Pinion at Rest	Mt. holes C/C	Voltage	Power Rating	Spigot Diameter	Mt. holes Diameter
9	25mm	11mm	2 Hole 83mm*	12	2.0hp	N/A	10mm

- 'Hitachi' style starter motor with solenoid on top.
- Suits 153 & 168 tooth ring gear. Dual inline bolt pattern

# CHEVROLET

## ALL LS-1-2-3+LSA ENGINES

G/R-01/LS-1.9

Commodore VT-VY-VX-VZ-VE-VF

Pinion Teeth	Pinion Diameter	Pinion at Rest	Mt. holes C/C	Voltage	Power Rating	Spigot Diameter	Mt. holes Diameter
10	27mm	11mm	2 Hole 73.30mm	12	1.9hp	N/A	10mm

- Will suit Manual or Automatic trans

## All LS-1-2-3+LSA Engines

G/R-01/LS-2.5

Commodore VT-VY-VX-VZ-VE-VF

Pinion Teeth	Pinion Diameter	Pinion at Rest	Mt. holes C/C	Voltage	Power Rating	Spigot Diameter	Mt. holes Diameter
10	27mm	11mm	2 Hole 73.30mm	12	2.5hp	N/A	10mm

- Will suit Manual or Automatic transmission

## LS-1-2-3+LSA Engines

G/R-01/LS-CONVERSIONS

Torana LC-LJ-LH-LX and HK-HT-HG HOLDENS

Pinion Teeth	Pinion Diameter	Pinion at Rest	Mt. holes C/C	Voltage	Power Rating	Spigot Diameter	Mt. holes Diameter
10	27mm	11mm	2 Hole 73.30mm	12	1.9hp	N/A	N/A

- Designed to fit LC-LJ Torana engine conversions where space is limited
- Will suit Manual or Automatic transmission

## ALL LS-1-2-3+LSA Engines

G/R-01/LS-SER.24V

24Volt Starter suit all LS 1-2-3 engines

Pinion Teeth	Pinion Diameter	Pinion at Rest	Mt. holes C/C	Voltage	Power Rating	Spigot Diameter	Mt. holes Diameter
			2 Hole				
10	27mm	11mm	73.30mm	24v	1.9hp	N/A	N/A

## ALL LS-1-2-3+LSA Engines

G/R-01/GENIILHS

LHS Mount

Pinion Teeth	Pinion Diameter	Pinion at Rest	Mt. holes C/C	Voltage	Power Rating	Spigot Diameter	Mt. holes Diameter
10	27mm	2mm	N/A	12	1.9hp	N/A	N/A

- Must be used with adaptor plate kit **G/R-01APA** (Auto), **G/R-01APM** (Manual), - **G/R-01-UNI** (Adaptor Plates Not Includes)
- Designed for engine conversions where Starter Motor must be mounted on LHS (eg. Early Commodore)

# CHEVROLET

---

## **LS-1, 2 and 3 LHS Adaptor Plate Kit - Factory Auto**

**G/R-01APA**

*Includes all parts needed to relocate starter motor to LHS*

---

## **LS-1, 2 and 3 LHS Adaptor Plate Kit - Manual T56**

**G/R-01APM**

*Includes all parts needed to relocate starter motor to LHS*

---

## **LS-1, 2 and 3 Adaptor Plate Kit**

**G/R-01AP-UNI**

*Suits T350, T400, Powerglide and Tri-Matic Auto Transmissions.*

Note: Custom Torque Converter Required for this application.

Option: You can use original Torque Converter if you purchase Flexplate 1834610

---

## **Chev/Oldsmobile Diesel**

**G/R-01/DIESEL**

5.7l

Pinion Teeth	Pinion Diameter	Pinion at Rest	Mt. holes C/C	Voltage	Power Rating	Spigot Diameter	Mt. holes Diameter
10	32mm	11.5mm	2 Hole 81.5mm	12	3HP	N/A	3/8 "

---

## **6cyl Chev 1934 -1936**

**G/R-01/6cyl**

Pinion Teeth	Pinion Diameter	Pinion at Rest	Mt. holes C/C	Voltage	Power Rating	Spigot Diameter	Mt. holes Diameter
10	40mm	18mm	2 Hole 105mm	12	1.9hp	70.3mm	12mm

Note: Pinion size or number of teeth may vary.

---

## **6cyl Blue Flame &Early V8**

**G/R-01/BLUE**

Pinion Teeth	Pinion Diameter	Pinion at Rest	Mt. holes C/C	Voltage	Power Rating	Spigot Diameter	Mt. holes Diameter
9	29mm	23mm	2 Hole 108mm	12	1.9hp	82.5mm	11mm

Will also suit 57 Chev with 265 - 283 engines and Cast Iron Powerglide

Note: Please advise if used in Truck application as position of starter is different due to Clutch pedal interference

---

## **Early 265-283 V8 with Cast Iron Powerglide Transmission**

**G/R-01**

Pinion Teeth	Pinion Diameter	Pinion at Rest	Mt. holes C/C	Voltage	Power Rating	Spigot Diameter	Mt. holes Diameter
9	25mm	11.5mm	3 Hole 59.38x80.29	12	1.9hp	76.2mm	3/8x5/16x3/8in

Will suit Chev with 265 - 283 engines and Cast Iron Powerglide



# CHRYSLER

**273-318-360-383-426-440 V8**

Suit Manual & Auto

**G/R-04/1.9**

**G/R-04/2.5**

Teeth	Diameter	Rest	C/C		Rating	Diameter	Diameter
10	32mm	24mm	2 Hole 110mm	12	1.9/2.5hp	88mm	11mm

Replaces: Bosch 9-000-063-021

**313-318 V8+ 6Cyl Hemi + Slant Six**

Suit AT-4 Dodge Truck

**G/R-04/313V8**

Pinion Teeth	Pinion Diameter	Pinion at Rest	Mt. holes C/C	Voltage	Power Rating	Spigot Diameter	Mt. holes Diameter
9	25mm	35m	104.4/ 62/84mm	12	1.9hp	82.5mm	11mm

• Supplied as 2 Bolt Mount

**354-392 HEMI V8**

**G/R-04/HEMI 392**

Replaces Original Chrysler unit.

Pinion Teeth	Pinion Diameter	Pinion at Rest	Mt. holes C/C	Voltage	Power Rating	Spigot Diameter	Mt. holes Diameter
9	25mm	21mm	2 Hole 105mm	12	1.9hp	82.5mm	10.5mm

• suits Chrysler 300D

*Note: Outer mesh must be checked before proceeding*

**354-392 HEMI V8**

**G/R-04/HEMI392/2.5**

Pinion Teeth	Pinion Diameter	Pinion at Rest	Mt. holes C/C	Voltage	Power Rating	Spigot Diameter	Mt. holes Diameter
9	25mm	21mm	2 Hole 105mm	12	2.5hp	82.5mm	10.5mm

**245-265 HEMI 6 Cylinder & Some V8's**

Also Suit Slant 6

**G/R-04/HEMI6**

Pinion Teeth	Pinion Diameter	Pinion at Rest	Mt. holes C/C	Voltage	Power Rating	Spigot Diameter	Mt. holes Diameter
9	25mm	24mm	2 Hole 110	12	1.9hp	88mm	11mm

• Check pinion diameter and no. of teeth

*NOTE: Also replaces Bosch 9-000-063-054 Gear Reduction Starter fitted with 10Tooth x 27mm Pinion.*

# CHRYSLER

## Chrysler Sidevalve

**G/R-04/SIDE**

Replaces original 6v Lucas M45G-26100B with 12 v unit.

Pinion Teeth	Pinion Diameter	Pinion at Rest	Mt. holes C/C	Voltage	Power Rating	Spigot Diameter	Mt. holes Diameter
9	29mm	37mm	3 hole 104.4mm	12	1.4kw	82.4mm	11mm

- Vehicle must be converted to 12v

# CRUSADER MARINE

## Replacement

G/R-11

Pinion Teeth	Pinion Diameter	Pinion at Rest	Mt. holes C/C	Voltage	Power Rating	Spigot Diameter	Mt. holes Diameter
9	25mm	45.5mm*	2 Hole 104.7mm	12	2.5hp	82.4mm	12.7mm (1/2 ")

- Replaces Delco 10MT 10A CCW series
- Anti-Clockwise rotation
- Check pinion at rest measurement with customer when ordering

# DESOTO

## Desoto 1959 361V8

G/R-62

Pinion Teeth	Pinion Diameter	Pinion at Rest	Mt. holes C/C	Voltage	Power Rating	Spigot Diameter	Mt. holes Diameter
9	25mm	32mm	2 Hole 101mm	12	2.5hp	88.8mm	1 threaded

- Replaces: Autolite/Chrysler 177995-MDT 6001

## Desoto 1954-1956 6cyl Sidevalve

G/R-04/Desoto

Pinion Teeth	Pinion Diameter	Pinion at Rest	Mt. holes C/C	Voltage	Power Rating	Spigot Diameter	Mt. holes Diameter
9	32mm	38mm	2 Hole 104.4mm	12	1.6hp	82.4mm	11mm

- Replaces: original 6v Delco with 12 v unit.

# Chrysler/Dodge / Plymouth V8 & 6cyl S/V Engines

## Dodge 6cyl S/V Engines

G/R-04/DODGE

Suits all 1936-56 Side Vave Engines

Pinion Teeth	Pinion Diameter	Pinion at Rest	Mt. holes C/C	Voltage	Power Rating	Spigot Diameter	Mt. holes Diameter
9	29mm	37mm	2 Hole 105mm	12	1.9hp	82.4mm	11mm

Replaces original 6v Delco with 12 v unit.

## Dodge 1927 4cyl and 1929 6cyl Side Valve

G/R-04/DODGE A

Pinion Teeth	Pinion Diameter	Pinion at Rest	Mt. holes C/C	Voltage	Power Rating	Spigot Diameter	Mt. holes Diameter
10	35.7mm	22mm	2 Hole 127mm	12	2hp	88.8mm	11mm

- The original 3 bolt mounting flange (127mm x 90mm x 90mm) is replaced by a 2 bolt flange.
- Replaces original 6v NORTHEAST ELECTRIC
- Vehicle must be converted to 12v

## Dodge 1930-36 6cyl Side Valve

G/R-04/DODGE B

Replaces Original 3 bolt mount with 2 bolt mount.

Pinion Teeth	Pinion Diameter	Pinion at Rest	Mt. holes C/C	Voltage	Power Rating	Spigot Diameter	Mt. holes Diameter
10	37.2mm	20.mm	2 Hole 127mm	12	1.4Kw	88.8mm	11mm

- The original 3 bolt mounting flange (127mm x 90mm x 90mm) is replaced by a 2 bolt flange.
- L.H.S Mount
- Vehicle must be converted to 12v

## Dodge Truck AT4-353 C.I.

G/R-04/353

Replacement - Also suits 1956 Dodge Royale Sedan

Pinion Teeth	Pinion Diameter	Pinion at Rest	Mt. holes C/C	Voltage	Power Rating	Spigot Diameter	Mt. holes Diameter
9	25mm	35mm	2 Hole 105mm	12	2.5hp	88.7mm	12.7mm (1/2 ")

Replaces Chrysler-Prestolite 2642692

## Dodge Truck 313 C.I.

G/R-04/313

suit Dodge and Desoto 50's with 313 c.i. engine

Pinion Teeth	Pinion Diameter	Pinion at Rest	Mt. holes C/C	Voltage	Power Rating	Spigot Diameter	Mt. holes Diameter
9	25mm	35mm	2 hole 105mm	12	1.4kw	82	11mm

Replaces Bosch 9-000-063-001

# DAIMLER

---

**Majestic 1958-63, Majestic Major 1961-66**

**G/R-37**

3.8ltr 6cyl

Pinion Teeth	Pinion Diameter	Pinion at Rest	Mt. holes C/C	Voltage	Power Rating	Spigot Diameter	Mt. holes Diameter
11	40mm	23mm	3 Hole 127/90/90	12	2.5hp	88.8mm	11mm

- Replaces Lucas M418G 25533D
- Hi-torque replacement has 2 bolt mount

---

**2.5Ltr V8 Saloon and SP 250 Dart**

**G/R-37A**

Suits

Pinion Teeth	Pinion Diameter	Pinion at Rest	Mt. holes C/C	Voltage	Power Rating	Spigot Diameter	Mt. holes Diameter
10	40mm	21mm	3 Hole 127/90/90	12	1.9hp	88.8mm	11mm

- Replaces Lucas M418G 25521D/E
  - Hi-torque replacement has 2 bolt mount
-

# FERRARI

## Ferrari F400 1976

G/R-38

V12

Pinion Teeth	Pinion Diameter	Pinion at Rest	Mt. holes C/C	Voltage	Power Rating	Spigot Diameter	Mt. holes Diameter
9	33mm	33mm	2 Hole 101mm	12	1.9hp	78mm	13mm

- Replaces Magnetti Marelli MT21T-1.8

## Ferrari 246 Dino 2.4Ltr 1972

G/R-38/Dino

V6

Pinion Teeth	Pinion Diameter	Pinion at Rest	Mt. holes C/C	Voltage	Power Rating	Spigot Diameter	Mt. holes Diameter
11	29mm	28mm	2 Hole 105mm	12	2.5HP	80.0mm	10.5mm

## Ferrari Model 512 Boxer 12 cyl

G/R-38/512

Replaces Magnetti Marelli

Pinion Teeth	Pinion Diameter	Pinion at Rest	Mt. holes C/C	Voltage	Power Rating	Spigot Diameter	Mt. holes Diameter
11	29mm	21mm	2 Hole 57.4 P.C.R	12	2.0 Kw	82.4mm	M8 x 1.25

## Ferrari 3Lt V8 - 308 and Mondial 1984-85

G/R-38/Mondial

Replaces Fiat E100-15/12-M2,11-Z11-4162784

Pinion Teeth	Pinion Diameter	Pinion at Rest	Mt. holes C/C	Voltage	Power Rating	Spigot Diameter	Mt. holes Diameter
11	29mm	21mm	3 Hole 74x80x114	12	2	82mm	M8 x 1.25

# FIAT

## 124 Coupe, Spider & Rally

G/R-12

Also Suit Lancia 125, 130, 2ltr, Lancia Beta

Pinion Teeth	Pinion Diameter	Pinion at Rest	Mt. holes C/C	Voltage	Power Rating	Spigot Diameter	Mt. holes Diameter
11	29mm	24mm	3 Hole 114/76/79	12	1.9hp	82.5mm	M8

- Passenger side mount

# FIAT continued

## Arbarth

**G/R-12/AB**

Pinion Teeth	Pinion Diameter	Pinion at Rest	Mt. holes C/C	Voltage	Power Rating	Spigot Diameter	Mt. holes Diameter
N/A	N/A	N/A	N/A	12	2.5hp	N/a	N/A

• Customer must supply complete original starter

## X19

**G/R-12/X19**

Pinion Teeth	Pinion Diameter	Pinion at Rest	Mt. holes C/C	Voltage	Power Rating	Spigot Diameter	Mt. holes Diameter
9	25mm	13mm	3 Hole 96/62/67mm	12	1.9hp	67	M8 x 1.2

## Fiat 850

**G/R-12/850**

*Counter-clockwise rotation*

Pinion Teeth	Pinion Diameter	Pinion at Rest	Mt. holes C/C	Voltage	Power Rating	Spigot Diameter	Mt. holes Diameter
9	25mm	13.5mm	3 Hole 89/66/52mm	12	1.6hp	103.8mm	11mm

## Fiat 131

**G/R-12/131**

*Drivers side mounting*

Pinion Teeth	Pinion Diameter	Pinion at Rest	Mt. holes C/C	Voltage	Power Rating	Spigot Diameter	Mt. holes Diameter
11	29mm	24mm	3 Hole 114mm	12	1.9hp	82.4mm	M 8 mm

Replaces Fiat E84-0.8/12 M2 11-Z9

## Fiat 1500 - 1963

**G/R-12/1500**

Pinion Teeth	Pinion Diameter	Pinion at Rest	Mt. holes C/C	Voltage	Power Rating	Spigot Diameter	Mt. holes Diameter
9mm	29mm	28mm	3 Hole 114/76/79	12	1.9hp	82.5mm	N/A

Replaces Fiat E100-1-5/12-VAR-1 or M25Z912009/MIN

# FORD

## V8 Windsor, Cleveland & 6cyl XP ---> BF

G/R-02/A1.9  
G/R-02/A2.5  
G/R-02/A3.0

Automatic Transmission (also suit T5 & T10 Manual incl. Tremec)

Pinion Teeth	Pinion Diameter	Pinion at Rest	Mt. holes C/C	Voltage	Power Rating	Spigot Diameter	Mt. holes Diameter
11	29mm	16mm	2 Hole 134mm	12	1.9/2.5hp	103.8mm	3/8"UNC

- Suits all Auto's (C4, C6 and C10)
- **NOTE: 11 Tooth pinion replaces original 9Tooth x 25mm dia**

## V8 Windsor, Cleveland & 6cyl

G/R-02/M1.9  
G/R-02/M2.5  
G/R-02/M3.0

Manual Transmission

Pinion Teeth	Pinion Diameter	Pinion at Rest	Mt. holes C/C	Voltage	Power Rating	Spigot Diameter	Mt. holes Diameter
11	29mm	9mm	2 Hole 134mm	12	1.9/2.5hp	103.8mm	3/8"UNC

- Suits Toploader 4 speed
- **NOTE: 11Tooth pinion replaces original 9Tooth x 25mm dia**

## Big Block 392-429-460

G/R-02/460-1.9  
G/R-02/460-2.5  
G/R-02/460-3.0

Suite Auto and Manual

Pinion Teeth	Pinion Diameter	Pinion at Rest	Mt. holes C/C	Voltage	Power Rating	Spigot Diameter	Mt. holes Diameter
11	29mm	11mm	2 Hole 134mm	12	1.9/2.5hp	103.8mm	11mm

- **NOTE: 11 Tooth pinion replaces original 9Tooth x 25mm dia**

## V8 Windsor & Cleveland

G/R-02/LHS

LHS Adaptor Kit

Pinion Teeth	Pinion Diameter	Pinion at Rest	Mt. holes C/C	Voltage	Power Rating	Spigot Diameter	Mt. holes Diameter
N/A	N/A	N/A	2 Hole N/A	N/A	N/A	N/A	N/A

- Includes sandwich plate, crank adaptor, adaptor plate & torque converter spacer.
- Starter motor not included. Use G/R-02/A1.9 or G/R-02/M1.9

## V8 Windsor & Cleveland

G/R-02/CCW 1.9  
G/R-02/CCW 2.5  
G/R-02/CCW 3.0

### Counter Clockwise Rotation

Suit Speed boats etc.

Pinion Teeth	Pinion Diameter	Pinion at Rest	Mt. holes C/C	Voltage	Power Rating	Spigot Diameter	Mt. holes Diameter
N/A	N/A	N/A	2 Hole N/A	N/A	N/A	N/A	N/A

- **NOTE: 11 Tooth pinion replaces original 9Tooth x 25mm dia**



# FORD

## 4.6 Ltr Modular Engine

S/F-1910

Pinion Teeth	Pinion Diameter	Pinion at Rest	Mt. holes C/C	Voltage	Power Rating	Spigot Diameter	Mt. holes Diameter
N/A	N/A	N/A	2 Hole N/A	N/A	N/A	N/A	N/A

## FALCON V8 EA-AU-BA 5.4LT

G/R-02/EA-AU-3HP

3HP Unit Mounts on Left Hand Side

Pinion Teeth	Pinion Diameter	Pinion at Rest	Mt. holes C/C	Voltage	Power Rating	Spigot Diameter	Mt. holes Diameter
10	27mm	17.3	3 Hole 67/65.5mm	12	3hp	76.3mm	3/8"UNC

103mm

## EFI Windsor

G/R-02/EA-AU

Replacement for EA-AU Ford Falcon. LHS mount

Pinion Teeth	Pinion Diameter	Pinion at Rest	Mt. holes C/C	Voltage	Power Rating	Spigot Diameter	Mt. holes Diameter
10	27mm	17.3mm	3 Hole 67/65.5mm	12	1.9hp	76.3mm	3/8 UNC

103mm

## 390-427-428 FE

G/R-02/FE-1

Also suit 272-292 Y-Block

Pinion Teeth	Pinion Diameter	Pinion at Rest	Mt. holes C/C	Voltage	Power Rating	Spigot Diameter	Mt. holes Diameter
9	29mm	16mm	3 Hole 134mm	12	1.9hp	103.3mm	10mm

- Replaces Inertia type starter as used on pre-1964 Galaxy also replaces Lucas M45G 26131A.
- Suits 152 tooth ring gear

## Sidevalve/Flathead

G/R-02/SIDE

Pinion Teeth	Pinion Diameter	Pinion at Rest	Mt. holes C/C	Voltage	Power Rating	Spigot Diameter	Mt. holes Diameter
11	40.5mm	25mm	2 Hole 88.9mm	12	1.9hp	76.2mm	11/32"

- Customer must specify what side the starter mounts on
- Pre-War engines may have smaller spigot and 66.0mm different outer mesh

# FORD

**390-427-428 FE**

**G/R-02/FE-2**

Pinion Teeth	Pinion Diameter	Pinion at Rest	Mt. holes C/C	Voltage	Power Rating	Spigot Diameter	Mt. holes Diameter
11	29mm	16mm	2 Hole 134mm	12	1.9hp	103.3mm	10mm

- Replaces Original Autolite Clapper type starter with 9t x 25mm Pinion
- Suits 183 tooth ring gear

**Capri V6**

**G/R-02/CAPRI**

For Capri 4cyl 1600, see G/R-02/ESCORT-C

Pinion Teeth	Pinion Diameter	Pinion at Rest	Mt. holes C/C	Voltage	Power Rating	Spigot Diameter	Mt. holes Diameter
9	29mm	17mm	2 Hole 146mm	12	1.9hp	96.5mm	11.6mm

**GT40**

**G/R-02/GT40**

Ford V8 fitted to Renault trans-axle

Pinion Teeth	Pinion Diameter	Pinion at Rest	Mt. holes C/C	Voltage	Power Rating	Spigot Diameter	Mt. holes Diameter
9	25mm	17mm	2 Hole 146mm	12	1.9hp	96.5mm	11.6mm

- Anti-clockwise rotation
- Spigot dimension may vary depending on manufacturer. Please check when ordering

**Sierra 1986-1990**

**G/R-02/SIERRA**

Cosworth Engine

Pinion Teeth	Pinion Diameter	Pinion at Rest	Mt. holes C/C	Voltage	Power Rating	Spigot Diameter	Mt. holes Diameter
10	27mm	13mm	3 Hole 6x66x104mm	12	1.9hp	76mm	M10

Replaces Bosch pt.no. 1005821059

# FORD

## **Cortina 1500 & 1600**

**G/R-02/CORTINA-A**

*Pushrod Engine.*

Pinion Teeth	Pinion Diameter	Pinion at Rest	Mt. holes C/C	Voltage	Power Rating	Spigot Diameter	Mt. holes Diameter
9 or 10	29mm	28mm	3 Hole 0.5x80.5x114mm	12	1.6hp	88.7mm	10mm

- LHS, 3 hole mount
- Will not suit twin cam engine
- Please advise the number of teeth on original pinion when ordering
- MKI Cortina & GT will need to have engine x-member modified approx. 10mm for starter clearance

## **Cortina 1500 Engine**

**G/R-02/CORTINA-B**

*Pushrod Engine.*

Pinion Teeth	Pinion Diameter	Pinion at Rest	Mt. holes C/C	Voltage	Power Rating	Spigot Diameter	Mt. holes Diameter
9 or 10	29mm	variable 28 or 31	2 Hole 114mm	12	1.6hp	88.7mm	10mm

- RHS, 2 hole mount suits only Mk1 & Mk2 with 1500cc Pushrod Engine.
- Will not suit twin cam engine
- Please advise the number of teeth on original pinion and the distance into Ring gear when ordering
- MKI Cortina & GT will need to have engine x-member modified approx. 10mm for starter clearance

## **Cortina 1500 Engine**

**G/R-02/CORTINA-C**

*Pushrod Engine.*

Pinion Teeth	Pinion Diameter	Pinion at Rest	Mt. holes C/C	Voltage	Power Rating	Spigot Diameter	Mt. holes Diameter
10	29mm	35mm	2 Hole 114mm	12	1.6hp	88.7mm	10mm

- RHS, 2 hole mount
- Will suit 1500cc engine with Datsun Crank fitted
- Please advise the number of teeth on original pinion when ordering
- MKI Cortina & GT will need to have engine x-member modified approx. 10mm for starter clearance

## **MK1 Escort**

**G/R-02/MK1ESCORT**

*1500 & 1600 Engines*

Pinion Teeth	Pinion Diameter	Pinion at Rest	Mt. holes C/C	Voltage	Power Rating	Spigot Diameter	Mt. holes Diameter
10	29mm	28mm	2 Hole 114mm	12	1.9hp	88mm	11mm

- LHS, 2 hole mount.
- Also suits Jensen Healey & Lotus
- Replaces Lucas M35 starter motors

# FORD

---

## **Escort 2ltr OHC Pinto & Kent**

**G/R-02/ESCORT-A**

Pinion Teeth	Pinion Diameter	Pinion at Rest	Mt. holes C/C	Voltage	Power Rating	Spigot Diameter	Mt. holes Diameter
10	27mm	28mm	80.5x80.5	12	1.9hp	88.7mm	10mm
			x114mm				

- LHS, 3 hole mount.
- Suits 2ltr Escort, Capri 2000, Cortina MK3 & MK4

---

## **Escort 2Ltr OHC Pinto & Cosworth**

**G/R-02/ESCORT-P**

Note: The same as G/R-02/Escort A except for the Outer Mesh 31mm

---

## **Escort Twin Cam**

**G/R-02/ESCORT-B**

Pinion Teeth	Pinion Diameter	Pinion at Rest	Mt. holes C/C	Voltage	Power Rating	Spigot Diameter	Mt. holes Diameter
9	29mm	28mm	80.5x80.5	12	1.9hp	88.7mm	10mm
			x114mm				

- LHS, 3 hole mount.
- Suits Cortina 1600, Lotus & RS1600. Will fit with world cup x-member

---

## **Escort Pushrod Engines**

**G/R-02/ESCORT-C**

Pinion Teeth	Pinion Diameter	Pinion at Rest	Mt. holes C/C	Voltage	Power Rating	Spigot Diameter	Mt. holes Diameter
10	29mm	28mm	80.5x80.5	12	1.9hp	88.7mm	10mm
			x114mm				

- LHS, 3 hole mount.

---

## **Zephyr 6cyl**

**G/R-02/ZEPHYR**

Pinion Teeth	Pinion Diameter	Pinion at Rest	Mt. holes C/C	Voltage	Power Rating	Spigot Diameter	Mt. holes Diameter
10	29mm	29mm	2 Hole	12	1.9hp	88.8mm	10.5mm
			127mm				

- Replaces Lucas M35G1L31-25022L
  - This starter is the same as G/R-23/Lucas-M35G and G/R-06/SP
-

# FORD

## Escort 2Ltr Zetec Engines

G/R-02/Zetec

Pinion Teeth	Pinion Diameter	Pinion at Rest	Mt. holes C/C	Voltage	Power Rating	Spigot Diameter	Mt. holes Diameter
10	27mm	14mm	80.5x80.5 x114mm	12	1.9hp	88mm	10mm

Suits 2Ltr Zetec Engines 1992 -98 Mk3 and Mk 4 Escorts

## Formula Ford 1600

G/R-02/FORMFORD

R.H.S 3 Hole Mount and MK-2 Cortina GT

Pinion Teeth	Pinion Diameter	Pinion at Rest	Mt. holes C/C	Voltage	Power Rating	Spigot Diameter	Mt. holes Diameter
9	29mm	28mm	80.5x80.5 x114mm	12	1.9hp	88.7mm	10mm

- NOTE: If Vehicle is fitted with Kent Engine and Hewland Trans it may need to use G/R-02/EA-AU Starter Motor
- Replaces Magnetti Marelli M790-9-27014B

## Ford Consul.

G/R-23/LUCAS-M35G

Replaces Lucas M35G 25022D

Pinion Teeth	Pinion Diameter	Pinion at Rest	Mt. holes C/C	Voltage	Power Rating	Spigot Diameter	Mt. holes Diameter
9	29mm	27mm	2 Hole 127mm	12	1.5hp	88.8mm	10.5mm

## Courier Diesel

G/R-02-Courier

Replaces Original Mitsubishi No M002T87271

Pinion Teeth	Pinion Diameter	Pinion at Rest	Mt. holes C/C	Voltage	Power Rating	Spigot Diameter	Mt. holes Diameter
10	32.5mm	20mm	3 Hole 94/75/136	12	2.5hp	81mm	10.5mm

Suits Ford Courier, Bravo, Econovan

1995-2005 Diesel WL Series 2.5Ltr

## Ford Pilot

G/R-02/Side-Pilot

English V8 Side Valve

Pinion Teeth	Pinion Diameter	Pinion at Rest	Mt. holes C/C	Voltage	Power Rating	Spigot Diameter	Mt. holes Diameter
9 or 10	40 or 29mm	28 or 26mm	2 Hole 127mm	12	1.5hp	66.0 or 72	10.5mm

Note: There is two starters. -- Advice the Pinion size and Spigot Diameter

# HARLEY DAVIDSON

## Evolution Engine

## G/R-13/EVO

Pinion Teeth	Pinion Diameter	Pinion at Rest	Mt. holes C/C	Voltage	Power Rating	Spigot Diameter	Mt. holes Diameter
N/A	N/A	24.5mm	3 Hole	12	1.9hp		

- 1/4" threaded drive shaft

## Sportster

## G/R-13/SPORT

Pinion Teeth	Pinion Diameter	Pinion at Rest	Mt. holes C/C	Voltage	Power Rating	Spigot Diameter	Mt. holes Diameter
9	29mm	19mm	3 Hole 76.5mm	12	1.6hp	54.9mm	3/8 UNF

- Suit 1988 model

## Evolution Engine

## G/R-13/2.5

Pinion Teeth	Pinion Diameter	Pinion at Rest	Mt. holes C/C	Voltage	Power Rating	Spigot Diameter	Mt. holes Diameter
N/A	N/A	24.5mm	3 Hole	12	2.5hp		

- M5 x .8 threaded drive shaft
- Adjustable end block

# HILLMAN

## **Minx, Super Minx, Hunter, Husky & Sceptre**

**G/R-14**

Also suit Singer Gazelle, Rapier & Arrow

Pinion Teeth	Pinion Diameter	Pinion at Rest	Mt. holes C/C	Voltage	Power Rating	Spigot Diameter	Mt. holes Diameter
9	29mm	28mm	2 Hole 127mm	12	1.9hp	88.8mm	11mm

- Same as G/R-23/LUCAS M35G
- Replaces Lucas 26026-41, 94, 103, 145
- Replaces Lucas M35J 25079J, 25149B, 25168E, 25132A
- Replaces Lucas M418G-25664B

## **Humber Snipe**

**G/R-14/SNIPE**

Replaces Lucas M45G 25612A

Pinion Teeth	Pinion Diameter	Pinion at Rest	Mt. holes C/C	Voltage	Power Rating	Spigot Diameter	Mt. holes Diameter
9 or 10	29mm	21mm	3 Hole 145/103/103	12	1.9hp	89.00mm	10.5mm

- Please advise the number of teeth on original pinion when ordering
- \* Not suitable for Auto DG Transmissions up to 1964.

## **Imp, Singer Chamois, Sunbeam Imp**

**G/R-09**

Use G/R-09

Pinion Teeth	Pinion Diameter	Pinion at Rest	Mt. holes C/C	Voltage	Power Rating	Spigot Diameter	Mt. holes Diameter
10	29mm	27mm	2 Hole 114mm	12	1.9hp	88mm	11mm

## **Humber Super Snipe 1964-67**

**G/R-14 /2 Hole Snipe**

Replaces Lucas M418G-25521D

Pinion Teeth	Pinion Diameter	Pinion at Rest	Mt. holes C/C	Voltage	Power Rating	Spigot Diameter	Mt. holes Diameter
10	40mm	29mm	3 Hole 127mm	12	1.9hp	89.00mm	10.5mm

- Same as G/R-06 except Outer of Mesh

# HOLDEN

## 253-308 V8

G/R-03/1.9

G/R-03/2.5

G/R-03/3.0

Pinion Teeth	Pinion Diameter	Pinion at Rest	Mt. holes C/C	Voltage	Power Rating	Spigot Diameter	Mt. holes Diameter
11	29mm	6mm	2 Hole 83mm	12	1.9/2.5hp	N/A	10mm

- Suits all Holden V8 engines with standard ring gear with 153 teeth.
- **NOTE: 11Tooth pinion replaces original 9Tooth x 25mm dia**
- **NOTE: Will not fit LC-LJ Torana fitted with Pacemaker headers**

## 253-308 V8 with 168 Tooth Ring Gear

G/R-03/11"

Pinion Teeth	Pinion Diameter	Pinion at Rest	Mt. holes C/C	Voltage	Power Rating	Spigot Diameter	Mt. holes Diameter
11	29mm	10.5mm	2 Hole 83mm	12	1.9hp	N/A	10mm

- Used with T5 & T56 transmission conversions and Rod Shop Conversions
- **NOTE: 11Tooth pinion replaces original 9Tooth x 25mm dia**
- **NOTE: Will not fit LC-LJ Torana fitted with Pacemaker headers**

## 6 Cylinder

G/R-03/6C1.9

G/R-03/6C2.5

G/R-03/6C3.0

Pinion Teeth	Pinion Diameter	Pinion at Rest	Mt. holes C/C	Voltage	Power Rating	Spigot Diameter	Mt. holes Diameter
9	25mm	2mm	2 Hole 105mm	12	1.9/2.5hp	82.4mm	10mm

- Suits all Red & Blue motor 6cyl engines

## RB30 6cyl Engine

G/R-03/RBSERIES

As used in VL Commodore/Nissan Skyline and suits all RB series Engines

Pinion Teeth	Pinion Diameter	Pinion at Rest	Mt. holes C/C	Voltage	Power Rating	Spigot Diameter	Mt. holes Diameter
9	29mm	7mm	2 Hole 110mm	12	1.9/2.5hp	82.3mm	11mm

- Replaces Bosch 9 000 064 001

## 6 Cyl Grey Engine

G/R-03/GREY

Pinion Teeth	Pinion Diameter	Pinion at Rest	Mt. holes C/C	Voltage	Power Rating	Spigot Diameter	Mt. holes Diameter
9	29mm	2mm	2 Hole 105mm	12	1.9/2.5hp	82.3mm	10mm



# HOLDEN

## **VN-VP-VQ-VR 3.8Ltr V6 Manual**

**G/R-03/V6M/1.9**

Pinion Teeth	Pinion Diameter	Pinion at Rest	Mt. holes C/C	Voltage	Power Rating	Spigot Diameter	Mt. holes Diameter
10	27mm	11mm	2 Hole 81.5mm	12	1.9hp	N/A	10mm

- Replaces Delco-Remy unit

## **VN-VT 3.8Ltr V6 Auto**

**G/R-03/V6A/1.9**

Pinion Teeth	Pinion Diameter	Pinion at Rest	Mt. holes C/C	Voltage	Power Rating	Spigot Diameter	Mt. holes Diameter
9	25mm	11mm	2 Hole 81.5mm	12	1.9hp	N/A	10mm

## **VN-VT 3.8Ltr V6 Auto Standard Replacement Unit**

**G/R-03/V6A**

Pinion Teeth	Pinion Diameter	Pinion at Rest	Mt. holes C/C	Voltage	Power Rating	Spigot Diameter	Mt. holes Diameter
9	25mm	11mm	2 Hole 81.5mm	12	1.9hp	N/A	10mm

## **Holden Rodeo**

*2 hole mount*

Pinion Teeth	Pinion Diameter	Pinion at Rest	Mt. holes C/C	Voltage	Power Rating	Spigot Diameter	Mt. holes Diameter
9	32mm	10mm	2 Hole 120mm	12	2.6hp	95mm	13mm

- LHS mount

## **Holden Rodeo**

*3 hole mount*

Pinion Teeth	Pinion Diameter	Pinion at Rest	Mt. holes C/C	Voltage	Power Rating	Spigot Diameter	Mt. holes Diameter
10	40mm	48mm	2 Hole 127/90/90	12	4hp	89mm	10mm

- LHS mount

# INTERNATIONAL

## **International V8 345**

**G/R-15/345/1.9**

*Also suits Scout*

Pinion Teeth	Pinion Diameter	Pinion at Rest	Mt. holes C/C	Voltage	Power Rating	Spigot Diameter	Mt. holes Diameter
9	25mm	40mm	2 Hole 105mm	12	1.9Hp	82.5mm	1/2"

Replaces Delco Remy 8-10 MT P/n 1109356 and Lucas M40 62925058D

## **International V8 345**

**G/R-15/345/2.5**

*Also suits Scout*

Pinion Teeth	Pinion Diameter	Pinion at Rest	Mt. holes C/C	Voltage	Power Rating	Spigot Diameter	Mt. holes Diameter
9	25mm	40mm	2 Hole 105mm	12	2.5Hp	82.5mm	1/2"

Replaces Delco Remy 8-10 MT P/n 1109356 and Lucas M40 62925058D

## **International V8 392**

**G/R-15/392**

Pinion Teeth	Pinion Diameter	Pinion at Rest	Mt. holes C/C	Voltage	Power Rating	Spigot Diameter	Mt. holes Diameter
9	25mm	56mm	2 Hole 105mm	12	2.5Hp	82.5mm	1/2"

## **International D3**

**G/R-15/D3**

Pinion Teeth	Pinion Diameter	Pinion at Rest	Mt. holes C/C	Voltage	Power Rating	Spigot Diameter	Mt. holes Diameter
13	40.7mm	22.5mm	2 Hole 108mm	12	2.5Hp	82.5mm	1/2"

Replaces Lucas M45g. Sample starter required.

## **AA120 6Cyl -240 PETROL**

**G/R-15/6cyl**

Pinion Teeth	Pinion Diameter	Pinion at Rest	Mt. holes C/C	Voltage	Power Rating	Spigot Diameter	Mt. holes Diameter
9	29mm	18mm	2 Hole 108mm	12	1.9hp	82.5mm	14mm

Replaces Lucas M40 62925076D, Ashdown 01-14149 and Baxter S-1060

# JAGUAR

## Jaguar V12

**G/R-16/1.9**  
**G/R-16/2.5**

Pinion Teeth	Pinion Diameter	Pinion at Rest	Mt. holes C/C	Voltage	Power Rating	Spigot Diameter	Mt. holes Diameter
11	29mm	16mm	2 Hole 127mm	12	1.9/2.5hp	88.8mm	3/8 UNC

- Replaces Lucas 26381D, 26327D, 26272D, 26346D

\* **NOTE:** 11Tooth pinion replaces original 9Tooth x 25mm dia

## Jaguar 6 Cylinder

**G/R-16/6C**

*XJ6 Series 1, 2 and 3 4.2ltr.*

Pinion Teeth	Pinion Diameter	Pinion at Rest	Mt. holes C/C	Voltage	Power Rating	Spigot Diameter	Mt. holes Diameter
9	29mm	25mm	2 Hole 127mm	12	1.9hp	88.8mm	10mm

- Replaces Lucas M45-260662, 3M100-25684H

## MKI Jaguar

**G/R-06**

*Use G/R-06*

Pinion Teeth	Pinion Diameter	Pinion at Rest	Mt. holes C/C	Voltage	Power Rating	Spigot Diameter	Mt. holes Diameter
10	40mm	21mm	2 Hole 127mm	12	1.9hp	88.8mm	11mm

## MKII Jaguar & XK140 & XK150

**G/R-16/MKII MAN+AUTO**

*2.4ltr, 3.4ltr & 3.8ltr Engines*

Pinion Teeth	Pinion Diameter	Pinion at Rest	Mt. holes C/C	Voltage	Power Rating	Spigot Diameter	Mt. holes Diameter
10	29/40mm	25.5mm	2 Hole 127m	12	1.9hp	88.8mm	11mm

- Replaces Lucas 26062A
- Ask customer what pinion is fitted to Starter Motor. The 10T x 40mm Manual or 10T x 29mm Pinion Auto

# JAGUAR

## MkII Jaguar Auto with Borg Warner Trans

**G/R-16/MKII BW AUTO**

2.4ltr, 3.4ltr & 3.8ltr Engines

Pinion Teeth	Pinion Diameter	Pinion at Rest	Mt. holes C/C	Voltage	Power Rating	Spigot Diameter	Mt. holes Diameter
10	29mm	46mm	2 Hole 127m	12	1.9hp	88.8mm	11mm

- Replaces Lucas 26097ED

## Jaguar XJ40

**G/R-16/XJ40**

Pinion Teeth	Pinion Diameter	Pinion at Rest	Mt. holes C/C	Voltage	Power Rating	Spigot Diameter	Mt. holes Diameter
9	29mm	27.5mm	2 Hole 127mm	12	1.9hp	88.8mm	3/8 UNC 11mm

- Replaces Bosch 1 001 110 011

## Jaguar XK120 and MK1

**G/R-16/XK120**

with course ring gear

Pinion Teeth	Pinion Diameter	Pinion at Rest	Mt. holes C/C	Voltage	Power Rating	Spigot Diameter	Mt. holes Diameter
10	29/40mm*	25.5mm	2 Hole 127mm	12	1.9hp	89	11mm

- Please advise the diameter of original pinion

## Jaguar E-Type

**G/R-16/4.2E**

4.2l

Pinion Teeth	Pinion Diameter	Pinion at Rest	Mt. holes C/C	Voltage	Power Rating	Spigot Diameter	Mt. holes Diameter
9	29mm	25mm	2 Hole 127mm	12	1.9hp	88.8mm	10mm

- Replaces Lucas m45-26131A
- NOTE: Can use G/R-16/C if customer does not require adjustable block

# JAGUAR

## Jaguar XK8

**G/R-16/XK8**

1997-1999 Supply as Change Over only

Pinion Teeth	Pinion Diameter	Pinion at Rest	Mt. holes C/C	Voltage	Power Rating	Spigot Diameter	Mt. holes Diameter
9	29mm	20mm	2 Hole 110mm	12	1.9hp	62.00mm	11mm - 12mm

- Replaces Nippon Denso 2280000-5091
- Supplied as Change Over Only

## Jaguar E-Type

**G/R-16/V12E**

V12

Pinion Teeth	Pinion Diameter	Pinion at Rest	Mt. holes C/C	Voltage	Power Rating	Spigot Diameter	Mt. holes Diameter
9	29mm	16mm	2 Hole 127mm	12	2.5hp	88.8mm	3/8 UNC

## Jaguar E-Type 3.8Ltr

**G/R-16/3.8E**

Pinion Teeth	Pinion Diameter	Pinion at Rest	Mt. holes C/C	Voltage	Power Rating	Spigot Diameter	Mt. holes Diameter
10	40mm	25.5mm	2 Hole 127mm	12	1.9Hp	88.8mm	11mm

# JENSEN

---

## Healey 1972-74

G/R-17

Use G/R-02/MKI Escort

Pinion Teeth	Pinion Diameter	Pinion at Rest	Mt. holes C/C	Voltage	Power Rating	Spigot Diameter	Mt. holes Diameter
			2 Hole				
10	29mm	28mm	114mm	12	1.9hp	88mm	11mm

- LHS, 2 hole mount.
- Can also use G/R-23 Lucas-M35G

---

## Jensen V8 Interceptor with Chrysler 383-440 Engine

G/R-04/1.9

Use G/R-04/1.9

Pinion Teeth	Pinion Diameter	Pinion at Rest	Mt. holes C/C	Voltage	Power Rating	Spigot Diameter	Mt. holes Diameter
			2 Hole				
10	32mm	24mm	110mm	12	1.9hp	88mm	11mm

---

# WILLYS JEEP

---

## Willys Jeep 4cyl. 1950's

G/R-72

Replaces Autolite MZ4137-47D

Pinion Teeth	Pinion Diameter	Pinion at Rest	Mt. holes C/C	Voltage	Power Rating	Spigot Diameter	Mt. holes Diameter
			2 Hole				
10	32mm	24mm	110mm	12	1.9hp	88mm	11mm

# LADA

**Niva & Bushman**

**G/R-18**

Pinion Teeth	Pinion Diameter	Pinion at Rest	Mt. holes C/C	Voltage	Power Rating	Spigot Diameter	Mt. holes Diameter
11	29mm	24mm	3 Hole 64.5/67mm	12	1.9hp	82.25mm	M8

# LANCIA

## Lancia Beta

G/R-12

Also suits Fiat 125, 130, 131 2ltr, 132

Pinion Teeth	Pinion Diameter	Pinion at Rest	Mt. holes C/C	Voltage	Power Rating	Spigot Diameter	Mt. holes Diameter
11	29mm	24mm	3 Hole 79/76mm	12	1.9hp	82.5mm	M8

## Lancia Fulvia 1957-69

G/R-12/FULVIA-1

Pinion Teeth	Pinion Diameter	Pinion at Rest	Mt. holes C/C	Voltage	Power Rating	Spigot Diameter	Mt. holes Diameter
8	27mm	16.5mm	2 Hole 89mm	12	1.9	61.9mm	8mm Thread

## Lancia Fulvia Second Series 1970 on

G/R-12/FULVIA-2

Pinion Teeth	Pinion Diameter	Pinion at Rest	Mt. holes C/C	Voltage	Power Rating	Spigot Diameter	Mt. holes Diameter
9	25mm	20mm	2 Hole 105mm	12	1.9	76mm	3.5mm Thread
<ul style="list-style-type: none"> <li>• Replaces Ducelliar 6206A 12V Clockwise Rotation</li> <li>• Replaces Bosch 0001208052 with 11Tooth x 29mm Pinion and Offset Block</li> </ul>							

## Lancia Flaminia 1962

G/R-12/FLAMINIA

Pinion Teeth	Pinion Diameter	Pinion at Rest	Mt. holes C/C	Voltage	Power Rating	Spigot Diameter	Mt. holes Diameter
9	25mm	20mm	2 Hole 101mm	12	1.9	76mm	11mm Thread
<ul style="list-style-type: none"> <li>• Replaces Magneti Marelli MT32/08/12/D9</li> </ul>							

## Lancia 131

G/R-12/FLAMINIA

Pinion Teeth	Pinion Diameter	Pinion at Rest	Mt. holes C/C	Voltage	Power Rating	Spigot Diameter	Mt. holes Diameter
9	25mm	20mm	2 Hole 101mm	12	1.9	76mm	11mm Thread
<ul style="list-style-type: none"> <li>• Replaces Magneti Marelli MT32/08/12/D9</li> </ul>							



# LEYLAND

**P76 V8**

**G/R-19**

Pinion Teeth	Pinion Diameter	Pinion at Rest	Mt. holes C/C	Voltage Voltage	Power Rating	Spigot Diameter	Mt. holes Diameter
9	25mm	41mm	2 Hole 118mm	12	1.9hp	84mm	11mm

- Replaces Lucas M450AK-62925078

# LOTUS

---

## **Elan 1968-73, Elite 1961-65, Super 7 1961-72 Twin Cam 1600**

Use G/R-02/MK1ESCORT

**G/R-02/MK1ESCORT**

Pinion Teeth	Pinion Diameter	Pinion at Rest	Mt. holes C/C	Voltage	Power Rating	Spigot Diameter	Mt. holes Diameter
9 or 10*	29mm	28mm	2 Hole 114mm	12	1.9hp	88mm	11mm

- Please advise the number of teeth on original starter motor pinion

---

## **Excel 4cyl**

**G/R-20/EXCEL**

Pinion Teeth	Pinion Diameter	Pinion at Rest	Mt. holes C/C	Voltage	Power Rating	Spigot Diameter	Mt. holes Diameter
9	29mm	26mm	2 Hole 127mm	12	1.9hp	88.8mm	11mm

- Replaces Lucas 3M100-25691B

---

## **Elise**

**G/R-20/ELISE**

Pinion Teeth	Pinion Diameter	Pinion at Rest	Mt. holes C/C	Voltage	Power Rating	Spigot Diameter	Mt. holes Diameter
9 or 10*	29mm	40mm	2 Hole 120.5mm	12	1.9hp	74.95mm	11mm

- Replaces Lucas 26835A
- Please advise the number of teeth on original starter motor pinion

---

## **Coventry Climax 2.5ltr**

**G/R-20/COV**

Pinion Teeth	Pinion Diameter	Pinion at Rest	Mt. holes C/C	Voltage	Power Rating	Spigot Diameter	Mt. holes Diameter
9 or 10	29mm	25mm	2 Hole 114mm	12	1.9hp	88.8mm	11mm

- Replaces Lucas 62925007
- Please advise the number of teeth on original starter motor pinion

---

## **Lotus 7(Ford engine) & MK9 (Climax Engine)**

**G/R-23/LUCAS-M35G**

Replaces Lucas M35G 25022A/D, 250220

Pinion Teeth	Pinion Diameter	Pinion at Rest	Mt. holes C/C	Voltage	Power Rating	Spigot Diameter	Mt. holes Diameter
9	29mm	28mm	2 Hole 127mm	12	1.9hp	88.8mm	11mm

# MAZDA

## Rotary 1st Generation Non-Turbo

G/R-40

Suit 10A, 12A & 13B RX7

Pinion Teeth	Pinion Diameter	Pinion at Rest	Mt. holes C/C	Voltage	Power Rating	Spigot Diameter	Mt. holes Diameter
13	40mm	Please Specify	2 Hole 140mm	C.C.W. 12	2.5hp	67mm	M10 12mm

- Suit non-turbo bellhousing
- Customer must specify pinion at rest measurement
- All Rotaries from 1971 → RX7 SC

## MADZA RX7 1993

G/R-40A

Suit 12A Turbo S4 and S5, RX7 13B TURBO

Pinion Teeth	Pinion Diameter	Pinion at Rest	Mt. holes C/C	Voltage	Power Rating	Spigot Diameter	Mt. holes Diameter
13	40mm	47.5mm	2 Hole 147mm	C.C.W. 12	2.5hp	66.9mm	M10 11.45mm

- Replaces: Mitsubishs Starter Motor M1T74181 12V 9323

## Rotary 1st Generation Turbo

G/R-40B

Suit 10A, 12A & 13B RX7

Pinion Teeth	Pinion Diameter	Pinion at Rest	Mt. holes C/C	Voltage	Power Rating	Spigot Diameter	Mt. holes Diameter
13	40mm	Please Specify	2 Hole 140mm	C.C.W. 12	2.5hp	67mm	M10 12mm

- Suit turbo bellhousing
- Customer must specify pinion at rest measurement

## Rotary Series 5,6,7,8

G/R-40C

All FD Rotaries Counter Clock Wise Rotation

Pinion Teeth	Pinion Diameter	Pinion at Rest	Mt. holes C/C	Voltage	Power Rating	Spigot Diameter	Mt. holes Diameter
13	40mm	Please Specify	2 Hole 140mm	C.C.W. 12	2.5hp	67mm	M10 12mm

- Replaces Mitsubishi M001T7-7581 and M001T7-5413

# Maserati

## 1990-Model 228 Coupe

G/R-42

Replaces Magnet Marelli E95-1/12 63221498

Pinion Teeth	Pinion Diameter	Pinion at Rest	Mt. holes C/C	Voltage	Power Rating	Spigot Diameter	Mt. holes Diameter
9	25mm	10.8	3 Hole - 56.6/ 56.5/87.8mm	12	1.9hp	67mm	M8 9mm

## Maserati V8 1950-60

G/R-42B

Replaces Bosch 0001-354-049 12Volt

Pinion Teeth	Pinion Diameter	Pinion at Rest	Mt. holes C/C	Voltage	Power Rating	Spigot Diameter	Mt. holes Diameter
11	40mm	20.5mm	2Hole 105 mm	12	2.5Hp	82	M8 12.5mm

## Maserati Sebring

G/R-42/Sebring

Replaces Magnet Marelli 1005823280

Pinion Teeth	Pinion Diameter	Pinion at Rest	Mt. holes C/C	Voltage	Power Rating	Spigot Diameter	Mt. holes Diameter
9	34mm	21mm	2 Hole 105mm	12	1.9hp	82	13

• 2 or 3 hole mount check with customer

## Maserati 1992-93-Model 222 SR Coupe

G/R-42A

Pinion Teeth	Pinion Diameter	Pinion at Rest	Mt. holes C/C	Voltage	Power Rating	Spigot Diameter	Mt. holes Diameter
9	25mm	14mm	3 Hole - 56.6/ 56.5, 87.8mm	12	1.9hp	62mm	M8 9mm

# Mercedes Benz

---

## Mercedes Benz SL190

G/R-39

Pinion Teeth	Pinion Diameter	Pinion at Rest	Mt. holes C/C	Voltage	Power Rating	Spigot Diameter	Mt. holes Diameter
			2				
9	29mm	15.5mm	105mm	12	1.9hp	85.9mm	10mm

- Replaces Bosch EED 0-8/12V CW R31.8T

---

## Mercedes Benz V8 600D-300SLE-600S-450SL

G/R-39A

M100 6.3Lt Engine

Pinion Teeth	Pinion Diameter	Pinion at Rest	Mt. holes C/C	Voltage	Power Rating	Spigot Diameter	Mt. holes Diameter
			4				
9	25mm	27mm	04.5mm PCD	12	2hp	82.4mm	M12

---

## Mercedes Benz V8 SLE 560 V8

G/R-39B

Replaces 0 001 313 006

Pinion Teeth	Pinion Diameter	Pinion at Rest	Mt. holes C/C	Voltage	Power Rating	Spigot Diameter	Mt. holes Diameter
			4				
9	25mm	11mm	105mm PCD	12	1.9hp	82.3mm	10mm

# Mitsubishi Jeep

## **Civilian Model Willy's Replica**

**G/R-50**

Replaces Mitsubishi 24v ccw Starter

Pinion Teeth	Pinion Diameter	Pinion at Rest	Mt. holes C/C	Voltage	Power Rating	Spigot Diameter	Mt. holes Diameter
11	34mm	58mm	3 Hole 44/105/105mm	24	4.5KWccw	100	11

## **Military Model Willy's Replica**

**G/R-50A**

Replaces M4T51177 ME007450

Pinion Teeth	Pinion Diameter	Pinion at Rest	Mt. holes C/C	Voltage	Power Rating	Spigot Diameter	Mt. holes Diameter
11	40mm	50mm	3 Hole 3x93x124mm	24	4.5KWccw	96	M12x1.75 12

# M.G.

Please Specify Size of Original Pinion and Lucas Starter Part Number when ordering

## **Midget 1275cc**

**G/R-22/M**

Pinion Teeth	Pinion Diameter	Pinion at Rest	Mt. holes C/C	Voltage	Power Rating	Spigot Diameter	Mt. holes Diameter
9	29mm	28mm	2 Hole 127mm	12	1.9hp	88.8mm	3/8" UNC 11mm

- Replaces Lucas 25147

## **MGB & GT 1962-196 and 1968-Australia**

**G/R-22/MGBMKI**

4Cyl 3 bearing crankshaft engine

Pinion Teeth	Pinion Diameter	Pinion at Rest	Mt. holes C/C	Voltage	Power Rating	Spigot Diameter	Mt. holes Diameter
9	29	28mm	2 Hole 127mm	12	1.9hp	89	11mm

- **Note Check Spigot and Pinion**
- Replaces Lucas 25555A
- Replaces original Inertia type starter motor 25616& 25604A

## **MGB & GT After 1967-68**

**Note Spigot and Pinion G/R-22/MGB MKII**

4Cyl 5 bearing crankshaft engine

Pinion Teeth	Pinion Diameter	Pinion at Rest	Mt. holes C/C	Voltage	Power Rating	Spigot Diameter	Mt. holes Diameter
10	32	28mm	2 Hole 127mm	12	1.9hp	83	11mm

- **Note Check Spigot and Pinion**
- Replaces Lucas 25654A and M40 62925042-A. Pre-Engaged Starter Motors

## **MGB V8 GT**

**G/R-28**

Pinion Teeth	Pinion Diameter	Pinion at Rest	Mt. holes C/C	Voltage	Power Rating	Spigot Diameter	Mt. holes Diameter
9	29mm	40mm	2 Hole 120mm	12	1.9hp	73mm	11mm

- Replaces Lucas 3M100-25701A

# M.G.

Please Specify Size of Original Pinion and Lucas Starter Part Number when ordering

## **MGC 6cyl**

**G/R-22/MGC**

Pinion Teeth	Pinion Diameter	Pinion at Rest	Mt. holes C/C	Voltage	Power Rating	Spigot Diameter	Mt. holes Diameter
10	32mm	28mm	2 Hole 127mm	12	1.9hp	82.5mm	10.5mm

- Replaces Lucas 25604A, M418G-26147A

## **MGF Late Model 4cyl**

**G/R-22/MGF**

Suit TF135, 120 & 160

Pinion Teeth	Pinion Diameter	Pinion at Rest	Mt. holes C/C	Voltage	Power Rating	Spigot Diameter	Mt. holes Diameter
10	27mm	40mm	2 Hole 120.5mm	12	1.9hp	75mm	13mm

- Replaces Magnetti Marelli 26835A
- Counter clock-wise rotation

## **MGA 1600 4cyl Twin Cam**

**G/R-22/MGA**

For MGA 1500 Pushrod Engine Use G/R-22/M

Pinion Teeth	Pinion Diameter	Pinion at Rest	Mt. holes C/C	Voltage	Power Rating	Spigot Diameter	Mt. holes Diameter
9	29mm	28mm	2 Hole 127mm	12	1.9hp	82.5mm	3/8" UNC 11mm

- Also suits early MG TD, TD, TF, 1500, 1600 & pre-1968 'B' engines

## **MG Magnette 1500 & 1622cc 1947-60 and**

**G/R-23/LUCAS-M35G**

## **MG Magnette 1275cc**

Pinion Teeth	Pinion Diameter	Pinion at Rest	Mt. holes C/C	Voltage	Power Rating	Spigot Diameter	Mt. holes Diameter
9	29mm	28mm	2 Hole 127mm	12	1.9hp	88.8mm	3/8"UNC

Replaces Lucas M35G 25022A/D, 25147



# MORRIS

## **Marina 4cyl 1973-75**

**G/R-02/MK1ESCORT**

Use G/R-02/MK1ESCORT

Pinion Teeth	Pinion Diameter	Pinion at Rest	Mt. holes C/C	Voltage	Power Rating	Spigot Diameter	Mt. holes Diameter
10	29mm	28mm	2 Hole 114mm	12	1.9hp	88mm	11mm

- LHS, 2 hole mount.

## **Minor 1000**

**G/R-23/LUCAS-M35G**

Pinion Teeth	Pinion Diameter	Pinion at Rest	Mt. holes C/C	Voltage	Power Rating	Spigot Diameter	Mt. holes Diameter
9 or 10	29mm	28mm	2 Hole 127mm	12	1.5hp	88.8mm	10.5mm

- Replaces Lucas M45G - 25022D and M35J-25345A
- Must shorten 3/8in. mounting bolt to 1in. long

## **Marina 6cyl**

**G/R-22/MGC**

Use G/R-22 / MGB-B

Pinion Teeth	Pinion Diameter	Pinion at Rest	Mt. holes C/C	Voltage	Power Rating	Spigot Diameter	Mt. holes Diameter
10	32mm	28mm	2 Hole 127mm	12	1.9hp	82.5mm	10.5mm

## **Morris Oxford**

**G/R-02/MK1ESCORT**

Use G/R-02/MK1ESCORT

Pinion Teeth	Pinion Diameter	Pinion at Rest	Mt. holes C/C	Voltage	Power Rating	Spigot Diameter	Mt. holes Diameter
10	29mm	28mm	2 Hole 114mm	12	1.9hp	88mm	11mm

- LHS, 2 hole mount.

## **Morris Vans J, J2, JB, Cowley 1953-60**

**G/R-23/LUCAS-M35G**

Replaces Lucas M35G 25022A/D

Pinion Teeth	Pinion Diameter	Pinion at Rest	Mt. holes C/C	Voltage	Power Rating	Spigot Diameter	Mt. holes Diameter
9 or 10	29mm	28mm	2 Hole 127mm	12	1.9hp	88.8mm	11mm

# MORRIS

## **MORRIS 8**

**G/R-23/LUCAS M35**

Replaces 6Volt 25040-L

Pinion Teeth	Pinion Diameter	Pinion at Rest	Mt. holes C/C	Voltage	Power Rating	Spigot Diameter	Mt. holes Diameter
9	35mm	27mm	2 Hole 127mm	12	1.5hp	88.8mm	11mm

# MORGAN

## **Morgan 4+4 1600cc**

**G/R-02/MK1ESCORT**

Use G/R-02/MK1ESCORT

Pinion Teeth	Pinion Diameter	Pinion at Rest	Mt. holes C/C	Voltage	Power Rating	Spigot Diameter	Mt. holes Diameter
10	29mm	28mm	2 Hole 114mm	12	1.9hp	88mm	11mm

- LHS, 2 hole mount.

## **Morgan 4+4 (Ford except crossflow 4cyl engines)**

**G/R-23/LUCAS-M35G**

Replaces Lucas M35G 25022A/D

Pinion Teeth	Pinion Diameter	Pinion at Rest	Mt. holes C/C	Voltage	Power Rating	Spigot Diameter	Mt. holes Diameter
9 or 10	29mm	28mm	2 Hole 127mm	12	1.9hp	88.8mm	11mm

# NISSAN

## **Patrol 1988-2012**

## **G/R-24/PATROL**

TB4500 Engine- ZD30 3Lt - TB42 - RD28T

Pinion Teeth	Pinion Diameter	Pinion at Rest	Mt. holes C/C	Voltage	Power Rating	Spigot Diameter	Mt. holes Diameter
9	35mm	11mm	2 Hole 110mm	12	1.9hp	82.3mm	11mm

• Replaces Hitachi S114-870 & OEX HXS027 - Hitachi S13-551A

## **Nissan/Datsun 180B, 200B & 2000 Sports**

## **G/R-24/L-SERIES**

## **G/R-24/LSERIES - 3HP**

also suits-L20,24,26,28,Z18,Z24,C240,C260,Z240,Z260,Z280 MQ-MkPatrol, 720 Ute, Skyline with L24

Pinion Teeth	Pinion Diameter	Pinion at Rest	Mt. holes C/C	Voltage	Power Rating	Spigot Diameter	Mt. holes Diameter
9	29mm	8mm	2 Hole 110mm	12	1.9hp	82.3mm	11mm

## **Nissan A series Engines**

## **G/R-24/A-SERIES**

## **G/R-24/A-SERIES 3HP**

Suits all A10 - A12 - A14 - A15 Engines

Pinion Teeth	Pinion Diameter	Pinion at Rest	Mt. holes C/C	Voltage	Power Rating	Spigot Diameter	Mt. holes Diameter
9	29mm	13.5mm	2 Hole 110mm	12	1.9hp	69.9mm	11mm

## **SKYLINE and GQ PATROL RB30 6cyl Engine**

## **G/R-03/RB SERIES**

VL Commodore/Nissan Skyline and suits all RB Series Engines

Pinion Teeth	Pinion Diameter	Pinion at Rest	Mt. holes C/C	Voltage	Power Rating	Spigot Diameter	Mt. holes Diameter
9	29mm	7mm	2 Hole 110mm	12	1.9/2.5hp	82.3mm	11mm

• Replaces Bosch 9 000 064 001

# NISSAN

## **Patrol 1988-2012**

## **G/R-24/SD 4CYL SERIES**

Suit Nissan 720 and Navara - Forklift SD22,23,25

Pinion Teeth	Pinion Diameter	Pinion at Rest	Mt. holes C/C	Voltage	Power Rating	Spigot Diameter	Mt. holes Diameter
9	35mm	12mm	2 Hole 110mm	12	1.9hp	82.3mm	11mm

## **NISSAN PRESIDENT V8 H252**

## **G/R-24/Y44**

Y44 Engine

Pinion Teeth	Pinion Diameter	Pinion at Rest	Mt. holes C/C	Voltage	Power Rating	Spigot Diameter	Mt. holes Diameter
9	29mm	7mm	2 Hole 110mm	12	3hp	94.9mm	12mm

# OLDSMOBILE

**3.5ltr V6**

**G/R 43**

Pinion Teeth	Pinion Diameter	Pinion at Rest	Mt. holes C/C	Voltage	Power Rating	Spigot Diameter	Mt. holes Diameter
9	25mm	37mm	2 Hole 118mm	12	1.9hp	70mm	10mm

**303 V8 ENGINE 1949 to1953**

**G/R 43/303-V8**

*Replaces Delco Inertia unit.*

Pinion Teeth	Pinion Diameter	Pinion at Rest	Mt. holes C/C	Voltage	Power Rating	Spigot Diameter	Mt. holes Diameter
9	29mm	24mm	2 Hole 105mm	12	1.9hp	82.5mm	12.5mm

**324 V8 ENGINE 1954 to1956**

**G/R 43/324-V8**

*Replaces Delco Remy 1107638-6A13*

Pinion Teeth	Pinion Diameter	Pinion at Rest	Mt. holes C/C	Voltage	Power Rating	Spigot Diameter	Mt. holes Diameter
9	25mm	23mm	2 Hole 105mm	12	1.9hp	82.5mm	12.5mm

**6CYL SIDE VALE**

**G/R-43/6CYL SIDE**

*SUIT 1936 OLDSMOBILE*

Pinion Teeth	Pinion Diameter	Pinion at Rest	Mt. holes C/C	Voltage	Power Rating	Spigot Diameter	Mt. holes Diameter
9	29mm	18mm	2 Hole 105mm	12	1.9hp	82.3mm	12.5mm

- Replaces Delco Remy
- Mounts on Passengers side.
- Note: Our Replacement Starter is supplied with 10Tooth x 32mm Pinion

**DX-350 Diesel**

**G/R-01 Diesel**

Pinion Teeth	Pinion Diameter	Pinion at Rest	Mt. holes C/C	Voltage	Power Rating	Spigot Diameter	Mt. holes Diameter
10	32mm	21mm	2 Hole 81.5mm	12	1.9hp	N/A	3/8"

- Also used in Chev and Pontiac

# PEUGEOT

**PEUGEOT 605 3Lt V6**

**G/R-60**

Replaces VALEO D6RA72-2263

Pinion Teeth	Pinion Diameter	Pinion at Rest	Mt. holes C/C	Voltage	Power Rating	Spigot Diameter	Mt. holes Diameter
9	25mm	N/A	N/A	12	1.9hp	N/A	N/A

# PLYMOUTH

**313ci**

**G/R-44**

Replaces Prestolite EBB Series

Pinion Teeth	Pinion Diameter	Pinion at Rest	Mt. holes C/C	Voltage	Power Rating	Spigot Diameter	Mt. holes Diameter
9	25mm	39mm	3 Hole 104/62/84	12	1.9hp	82.4mm	11mm

# PONTIAC

**350-455 V8**

LHS Mount

**G/R-26/1.9**

**G/R-26/2.5**

Pinion Teeth	Pinion Diameter	Pinion at Rest	Mt. holes C/C	Voltage	Power Rating	Spigot Diameter	Mt. holes Diameter
9	25mm	11mm	2 Hole 81.5mm	12	1.9/2.5hp	N/A	10mm

# PORSCHE

## 911 & 915

**G/R-27**

*Anti-Clockwise Rotation fitted with G50 Trans.*

**G/R-27/2.5**

Pinion Teeth	Pinion Diameter	Pinion at Rest	Mt. holes C/C	Voltage	Power Rating	Spigot Diameter	Mt. holes Diameter
9	25mm	33mm	2 Hole 105mm	12	1.9hp	75.9mm	11mm

- Also available in 2.5HP Starter
- NOTE: G/R-27 is 1.9Hp Starter and G/R-27/2.5 is 2.5Hp Starter
- NOTE: some transmissions may have 2mm offset housing.
- Replaces Bosch 0-000-212-005 up to 1989. From 1990 to 2009 use 10T x 27mm pinion.

## 944

**G/R-27/944**

*Anti-Clockwise Rotation*

Pinion Teeth	Pinion Diameter	Pinion at Rest	Mt. holes C/C	Voltage	Power Rating	Spigot Diameter	Mt. holes Diameter
9	25mm	20mm	2 Hole 127mm	12	1.9hp	82.4mm	11mm

## 944

**G/R-27/944A**

*Anti-Clockwise Rotation*

Pinion Teeth	Pinion Diameter	Pinion at Rest	Mt. holes C/C	Voltage	Power Rating	Spigot Diameter	Mt. holes Diameter
9	25mm	22mm	2 Hole 105mm	12	1.9hp	82.4mm	11mm

- Replaces Bosch 0001311134-12V

## 928

**G/R-27/928**

*Clockwise Rotation*

Pinion Teeth	Pinion Diameter	Pinion at Rest	Mt. holes C/C	Voltage	Power Rating	Spigot Diameter	Mt. holes Diameter
9	25mm	33mm	2 Hole 105mm	12	1.9hp	75.9mm	11mm

## 356

**G/R-27/356**

*Anti-Clockwise Rotation*

Pinion Teeth	Pinion Diameter	Pinion at Rest	Mt. holes C/C	Voltage	Power Rating	Spigot Diameter	Mt. holes Diameter
9	29mm	33mm	2 Hole 105	12	1.9hp	75.9mm	11mm

- Replaces Bosch AL/EES 6 volt units



# RAMBLER

**360-460 V8 AMC**

**G/R-33**

*Replaces Clapper type Starter*

Pinion Teeth	Pinion Diameter	Pinion at Rest	Mt. holes C/C	Voltage	Power Rating	Spigot Diameter	Mt. holes Diameter
9	25mm	18mm	2 Hole 136mm	12	2.5hp	82.4mm	3/8 UNC 11.5mm

# RENAULT

## Renault R17TL 1974

**G/R-58**

Pinion Teeth	Pinion Diameter	Pinion at Rest	Mt. holes C/C	Voltage	Power Rating	Spigot Diameter	Mt. holes Diameter	Mounting Side
9	25mm	20mm	3 Hole 115/80/80	12	1.6hp	81.9mm	11mm	R

## Renault Megane and Forklift Applications

**G/R-58A**

Pinion Teeth	Pinion Diameter	Pinion at Rest	Mt. holes C/C	Voltage	Power Rating	Spigot Diameter	Mt. holes Diameter	Mounting Side
10	27mm	minus 2mm	4 Hole check below	12	1.6hp	81.9mm	11mm	R

- Bolt hole P.C.D. 104 x 106.5 x 104 x 145mm
- Replaces Valeo O.E.M.
- Replaces Cooldrive 70-1068
- Replaces Baxter 432590

# RILEY

**1948 Riley 2.5 Ltr**

**G/R-30 Riley**

Pinion Teeth	Pinion Diameter	Pinion at Rest	Mt. holes C/C	Voltage	Power Rating	Spigot Diameter	Mt. holes Diameter	Mounting Side
10	40mm	26mm	3 Hole 103/103/146	12	1.9Hp	92	11	L

*Replaces Lucas M45G - 26043A and B*

**Riley 1500cc 1958-59**

**G/R-23/LUCAS-M35G**

*Replaces Lucas M35G 25022A/D*

Pinion Teeth	Pinion Diameter	Pinion at Rest	Mt. holes C/C	Voltage	Power Rating	Spigot Diameter	Mt. holes Diameter
9	29mm	28mm	2 Hole 127mm	12	1.9hp	88.8mm	11mm

# ROVER - LANDROVER

## 3500 Series 1987-95

G/R-28

Also suits Landrover, RangeRover V8's 22D,22F, 37D, 38D, MGB V8 & Triumph TR7 V8.

Pinion Teeth	Pinion Diameter	Pinion at Rest	Mt. holes C/C	Voltage	Power Rating	Spigot Diameter	Mt. holes Diameter
9	25mm	40mm	2 Hole 120mm	12	1.9hp	73mm	11mm

- Replaces Lucas 3M100-25701A and 25366A also LRS-318

## Landrover Series 2 & 3 Diesel

G/R-28/Series 2 and 3

Pinion Teeth	Pinion Diameter	Pinion at Rest	Mt. holes C/C	Voltage	Power Rating	Spigot Diameter	Mt. holes Diameter
11	40mm	21mm	2 Hole 127mm	12	2.5hp	88.8mm	11mm

- Replaces Lucas 2M100, 25668B
- Can also be used to Replace M45G-26132 3 bolt mount.

## Landrover 1961-72 4cyl Petrol

G/R-28 Petrol  
Same as G/R-06

Pinion Teeth	Pinion Diameter	Pinion at Rest	Mt. holes C/C	Voltage	Power Rating	Spigot Diameter	Mt. holes Diameter
10	40mm	21mm	2 Hole 127mm	12	1.6hp	88.8mm	11mm

- Replaces Lucas 2M100-25668B/D, M418G-25521D and M45G-26183F

## Landrover 1955-60 Series 1

G/R-28 Series 1

Replaces Lucas M418G 25514A, 25533B & A

Pinion Teeth	Pinion Diameter	Pinion at Rest	Mt. holes C/C	Voltage	Power Rating	Spigot Diameter	Mt. holes Diameter
11	40mm	35mm	3 Hole 127x90x90	12	1.6hp	95.1mm	11mm

Hi-Torque end plate uses 2 bolt flange with 127mm C/C

## Rover 75, 90, All petrol models 1955-60

G/R-37

Replaces Lucas M418G 25533B

Pinion Teeth	Pinion Diameter	Pinion at Rest	Mt. holes C/C	Voltage	Power Rating	Spigot Diameter	Mt. holes Diameter
11	40mm	28mm	3 Hole 10x90x127mm	12	1.6hp	89	11mm

Hi-Torque end plate uses 2 bolt flange with 127mm C/C

# SAAB

## 9000 Series

**G/R-57**

Replaces Bosch 0 001 108 091

Pinion Teeth	Pinion Diameter	Pinion at Rest	Mt. holes C/C	Voltage	Power Rating	Spigot Diameter	Mt. holes Diameter
9	25mm	19mm	2 Hole 110mm	12	1.9hp	88.8mm	8.5mm

## 900 Gli

**G/R-57**

Replaces Bosch 0 001 811 108

Pinion Teeth	Pinion Diameter	Pinion at Rest	Mt. holes C/C	Voltage	Power Rating	Spigot Diameter	Mt. holes Diameter
9	25mm	7mm	2 Hole 114mm	12	1.9hp	88.5mm	11mm

- Mount on front of engine

# SINGER

**Gazelle, Hunter, SM1200, 1500, 9HP, 1950-51 Vans G/R-23/LUCAS-M35G**

*Replaces Lucas M35G 25022A/D and M4189-25664B*

Pinion Teeth	Pinion Diameter	Pinion at Rest	Mt. holes C/C	Voltage	Power Rating	Spigot Diameter	Mt. holes Diameter
9	29mm	28mm	2 Hole 127mm	12	1.9hp	88.8mm	11mm

# STANDARD

## **Standard 8, 10, Atlas Van, & Pennant.**

**G/R-23/LUCAS-M35G**

*Replaces Lucas M35G 25022A/D*

Pinion Teeth	Pinion Diameter	Pinion at Rest	Mt. holes C/C	Voltage	Power Rating	Spigot Diameter	Mt. holes Diameter
9	29mm	28mm	2 Hole 127mm	12	1.9hp	88.8mm	11mm

## **Standard Vanguard Phase1-3**

**G/R-30/MFG**

Pinion Teeth	Pinion Diameter	Pinion at Rest	Mt. holes C/C	Voltage	Power Rating	Spigot Diameter	Mt. holes Diameter
9	29mm	29mm	2 Hole 105mm	12	1.9hp	72.6mm	11mm

## **Standard Vanguard 6cyl 2000cc**

**G/R-31/TR6**

*Replaces Lucas M418G 25626A/D*

Pinion Teeth	Pinion Diameter	Pinion at Rest	Mt. holes C/C	Voltage	Power Rating	Spigot Diameter	Mt. holes Diameter
9	29mm	20mm	2 Hole 127mm	12	1.9hp	98mm	11mm

# SUNBEAM TALBOT

## 90 Series

G/R-06

Use G/R-06

Pinion Teeth	Pinion Diameter	Pinion at Rest	Mt. holes C/C	Voltage	Power Rating	Spigot Diameter	Mt. holes Diameter
10	40mm	21mm	2 Hole 127mm	12	1.9hp	88.8mm	11mm

## Rapier & Alpine

G/R-23/LUCAS-M35G

Replaces Lucas M35G 25022A/D

Pinion Teeth	Pinion Diameter	Pinion at Rest	Mt. holes C/C	Voltage	Power Rating	Spigot Diameter	Mt. holes Diameter
9	29mm	28mm	2 Hole 127mm	12	1.9hp	88.8mm	11mm

# SUBARU

## SUBARU

G/R-55

EJ Series manual

Pinion Teeth	Pinion Diameter	Pinion at Rest	Mt. holes C/C	Voltage	Power Rating	Spigot Diameter	Mt. holes Diameter
9	29mm	48mm	2 Hole 120mm	12	1.9hp	64.8mm	11mm

Replaces M001T77981 Subaru pt. no. 23300-AA311

# TALBOT

## TALBOT

G/R-66

LARGO 1950 6 Cyl.

Pinion Teeth	Pinion Diameter	Pinion at Rest	Mt. holes C/C	Voltage	Power Rating	Spigot Diameter	Mt. holes Diameter
10	39.5mm	33mm	2 Hole 127mm	12	2.5Hp	94.5mm	11mm

Replaces - Paris Rhone Type D11B14 - N36559 - 3-Bolt Mount



# TOYOTA

## Landcruiser 1973-85

G/R-29

Petrol FJ40, FJ45 & FJ60 6Cyl Diesel

Pinion Teeth	Pinion Diameter	Pinion at Rest	Mt. holes C/C	Voltage	Power Rating	Spigot Diameter	Mt. holes Diameter
9	29	19.5mm	2 Hole 105mm	12	1.4 Kw	82.5mm	13mm

- Require original starter

## Toyota Hilux 3Ltr and 5Ltr Engine

G/R-29/HILUX

LN-111R - 1994 on

Pinion Teeth	Pinion Diameter	Pinion at Rest	Mt. holes C/C	Voltage	Power Rating	Spigot Diameter	Mt. holes Diameter
10	38mm	15mm	2 Hole 135mm	12	2.8hp	82mm	13mm/ M12 x 1.5

- RHS mount

## Toyota Tarago 1990-1993

Suits 2.4Ltr Petrol 2TZ-FE

Pinion Teeth	Pinion Diameter	Pinion at Rest	Mt. holes C/C	Voltage	Power Rating	Spigot Diameter	Mt. holes Diameter
9	29mm	21mm	3 Hole 120x97x94	12	2.0KW	74	13mm/ M12 x 1.5

- LHS mount

## Toyota Corolla 1994-97

G/R-29/Cor

4 - AGE - 20V

Same Spec as S/N-1700R

Pinion Teeth	Pinion Diameter	Pinion at Rest	Mt. holes C/C	Voltage	Power Rating	Spigot Diameter	Mt. holes Diameter
9	29mm	19mm	2 Hole 116mm	12	1.4Kw	74mm	11.5mm

- Replaces N/D 28100-16071 & 128000-5682

# TRIUMPH

## TR2 & Early TR3 up to chassis #50 000

G/R-06

Use G/R-06

Pinion Teeth	Pinion Diameter	Pinion at Rest	Mt. holes C/C	Voltage	Power Rating	Spigot Diameter	Mt. holes Diameter
10	40mm	21mm	2 Hole 127mm	12	1.9hp	88.8mm	11mm

## TR3A

G/R-31/TR3A

Also suit TR4, GT6 & Spitfire 1963-80. After chassis #50001

Pinion Teeth	Pinion Diameter	Pinion at Rest	Mt. holes C/C	Voltage	Power Rating	Spigot Diameter	Mt. holes Diameter
10	40mm	27mm	2 Hole 127mm	12	1.9hp	88.8mm	11mm

- Replaces Lucas M418G 25541F, 25550A

## TR6 & 2500Ti

G/R-31/TR6

Suits 2000, 2500S, GT6, TR5 & TVR with Triumph engine

Pinion Teeth	Pinion Diameter	Pinion at Rest	Mt. holes C/C	Voltage	Power Rating	Spigot Diameter	Mt. holes Diameter
9	29mm	27.5	2 Hole 127mm	12	1.9hp	88.8mm	11mm

- Replaces Lucas M418G 25626 & 2M100-25714A
- Check the number of pinion teeth and diameter on original starter motor G/R-06/SP may suit better

## TR6 & 2500Ti

G/R-06/SP

Suits 2000, 2500S, GT6, TR5 & TVR with Triumph engine

Pinion Teeth	Pinion Diameter	Pinion at Rest	Mt. holes C/C	Voltage	Power Rating	Spigot Diameter	Mt. holes Diameter
10	29	27.5	2 Hole 127mm	12	1.9hp	88.8mm	11mm

- Replaces Lucas M418G-25541E, 25526A, 25511D
- Same starter as Austin Healy Sprite

## TR7 & Dolomite Sprint

G/R-31/TR7

Pinion Teeth	Pinion Diameter	Pinion at Rest	Mt. holes C/C	Voltage	Power Rating	Spigot Diameter	Mt. holes Diameter
10	29	14.5mm	2 Hole 110-114mm	12	1.9hp	88mm	11mm

- Replaces Lucas 2M100 & 3M100 25677B, 25703, 25717

## Dolomite 1300 & 1500 Sedan

G/R-31-DOLOMITE

- Check pinion teeth and diameter on original starter motor

Pinion Teeth	Pinion Diameter	Pinion at Rest	Mt. holes C/C	Voltage	Power Rating	Spigot Diameter	Mt. holes Diameter
9	25	14.5mm	2 Hole 110-114mm	12	1.9hp	88mm	11mm

- Replaces Lucas 25698, 25687, 25213

# TRIUMPH

## TR3

G/R-30/MFG

Using fine ring gear. Use G/R-30/MFG

Pinion Teeth	Pinion Diameter	Pinion at Rest	Mt. holes C/C	Voltage	Power Rating	Spigot Diameter	Mt. holes Diameter
9 or 10	29/40mm	29mm	2 Hole 105mm	12	1.9hp	72.6mm	11.5mm

- Check pinion teeth and diameter of original starter motor

Also suit TR4, GT6 & Spitfire 1963-80. After chassis #50001

## V8 Stag

G/R-31/STAG-M

with Rover V8 engines.

Pinion Teeth	Pinion Diameter	Pinion at Rest	Mt. holes C/C	Voltage	Power Rating	Spigot Diameter	Mt. holes Diameter
9	25mm	40mm	2 Hole 127mm	12	1.9hp	88.8mm	11mm

- Replaces Lucas M418G 25627E

## V8 Stag

G/R-31/STAG-A

with early Triumph Engines.

Pinion Teeth	Pinion Diameter	Pinion at Rest	Mt. holes C/C	Voltage	Power Rating	Spigot Diameter	Mt. holes Diameter
9	25mm	18mm	2 Hole 127mm	12	1.9hp	88.8mm	11mm

- Replaces Lucas M418G 25648 and 2M100-25648H

## Vitesse/2000/Spirfire '4'

G/R-14

Use G/R-14

Pinion Teeth	Pinion Diameter	Pinion at Rest	Mt. holes C/C	Voltage	Power Rating	Spigot Diameter	Mt. holes Diameter
9	29mm	28mm	2 Hole 127mm	12	1.9hp	82.5mm	11mm

# VAUXHALL

**Vauxhall Viscount 1971 PC Automatic**

**G/R-23/LUCAS M35G**

*Replaces Lucas M418G-256648*

Pinion Teeth	Pinion Diameter	Pinion at Rest	Mt. holes C/C	Voltage	Power Rating	Spigot Diameter	Mt. holes Diameter
10	40mm	21mm	2 Hole 127mm	12	1.9hp	88.8mm	11mm

# VOLKSWAGEN

## Short Bellhousing

G/R-32

Suit air cooled 1200, 1500, 1600 & 1800. Also suit 2ltr Auto

Pinion Teeth	Pinion Diameter	Pinion at Rest	Mt. holes C/C	Voltage	Power Rating	Spigot Diameter	Mt. holes Diameter
9	25mm	33mm	2 Hole 105mm	12	1.9hp	75.9mm	1/2"

- Counter-clockwise rotation

## Long Bellhousing

G/R-32/2ltr

Suit 2ltr *Caravelle*, *Karmen Ghia* & *Transporter*

Pinion Teeth	Pinion Diameter	Pinion at Rest	Mt. holes C/C	Voltage	Power Rating	Spigot Diameter	Mt. holes Diameter
9	25mm	49/46mm*	2 Hole 105mm	12	1.9hp	76.1mm	10mm

- Counter-clockwise rotation
- Check pinion at rest measurement when ordering. Standard 2ltr has pinion at rest measurement of 46mm, - *Caravelle*, *Karmen Ghia* and *Transporter* has 49mm
- Suits Albins Transmission

## Short Bellhousing

G/R-32/6VOLT

Pinion Teeth	Pinion Diameter	Pinion at Rest	Mt. holes C/C	Voltage	Power Rating	Spigot Diameter	Mt. holes Diameter
9	29mm	33mm	2 Hole 105mm	12v	1.9hp	75.9mm	1/2"

- Counter-clockwise rotation

NOTE: Replaces original 6 Volt with 12 Volt unit Fitted with 6 Volt ring gear

# WOLSELEY

---

## Hornet, 1300, 1100

G/R-09

Use G/R-09

Pinion Teeth	Pinion Diameter	Pinion at Rest	Mt. holes C/C	Voltage	Power Rating	Spigot Diameter	Mt. holes Diameter
10	29mm	27mm	2 Hole 114mm	12	1.9hp	88mm	11mm

---

## Wolseley 1500, 1560, 1660

G/R-09

Pinion Teeth	Pinion Diameter	Pinion at Rest	Mt. holes C/C	Voltage	Power Rating	Spigot Diameter	Mt. holes Diameter
10	40mm	28mm	2 Hole 114mm	12	1.9hp	88mm	11mm

- Replaces Lucas M35 25083

---

## Wolseley 6/99, 6/110

G/R-06

Pinion Teeth	Pinion Diameter	Pinion at Rest	Mt. holes C/C	Voltage	Power Rating	Spigot Diameter	Mt. holes Diameter
10	40mm	21mm	2 Hole 114mm	12	1.9hp	88mm	11mm

- Replaces Lucas 25521D
-

# PARTS & ACCESSORIES

---

<b>9T x 25mm Pinion</b>	<b>CAE-110</b>
<b>9T x 25mm Pinion to suit Counter Clockwise Starters</b>	<b>CAE-110CCW</b>
<b>9T x 25mm Pinion for Tilton/Hitachi Starters</b>	<b>CAE-197</b>
<b>10T x 27mm Pinion</b>	<b>CAE-114</b>
<b>11T x 29mm Pinion</b>	<b>CAE-217</b>
<b>10T x 29mm English Pinion</b>	<b>CAE-251</b>
<b>9T x 29mm English Pinion</b>	<b>CAE-243</b>
<b>Drive Circlip</b>	<b>7605-8201</b>
<b>Drive Retainer</b>	<b>7606-8201</b>
<b>Drive Pinion Spring</b>	<b>5406-8203</b>
<b>Serrated Washer for Drive</b>	<b>7605-8202</b>
<b>Drive Clutch Assembly (1.9hp)</b>	<b>5401-8202</b>
<b>Drive Clutch Assembly (1.6hp &amp; 2.5hp)</b>	<b>8400-8212</b>
<b>Intermediate Gear Roller</b>	<b>7608-8201</b>
<b>Plunger &amp; Contact Assembly</b>	<b>6603-8203</b>
<b>Copper Contacts</b>	<b>6621-8206</b>
<b>Silver Body Solenoid Assy - LH Switch</b>	<b>5302-8148</b>
<b>Silver Body Solenoid Assy - RH Switch</b>	<b>5302-8149</b>
<b>Bakerlite Solenoid Terminal Housings 1.6hp &amp; 2.5hp Units</b>	<b>7651-8204</b>
<b>Bakelite Solenoid Terminal Housings 1.9hp Units</b>	<b>7601-8204</b>
<b>2mm Shim to move Starter away from Flywheel</b>	<b>CAE-039A</b>
<b>1mm Shim to move Starter away from Flywheel</b>	<b>CAE-039B</b>
<b>Ford Spacer Plate to adapt Ford V8 Auto Starter to Manual Application</b>	<b>CAE-283</b>
<b>Auto Flexplate for transmission conversion G/R-01AP-UNI ref. page 16</b>	<b>1834610</b>
<b>Crank shaft bung/spigot for use with transmission conversion G/R-01AP-UNI ref. page 16</b>	<b>1800346</b>

***If you require a part that is not listed, please call us.***

# WIPER MOTOR - CABLE DRIVE KITS

---

**All Wiper Kits include Wiring Loom with 2 Speed Self Park Rotary Switch**

**All Wiper Kits are available with Intermittent 2 Speed Self Park Rotary Switch**

---

## **Chev 1949-52 Cable Drive**

Cable drive wiper motor kit mounts beneath dash, supplied with Arms & Blades

**NOTE: Customer Original Posts required for rework.**

**W/M-CHEV-1949-52C/D**

30-1-2013

N/A till further notice.

---

## **Chev 1953-54 Cable Drive**

Cable drive wiper motor kit for Chev 1953-54

**NOTE: Customer Original Posts required for rework.**

**W/M-CHEV-1953-54 C/D**

---

## **Chev 1955-56 Cable Drive**

Cable drive wiper motor kit for Chev 1955-56

**W/M-CHEV-1955-56 C/D**

---

## **Chev 1957 Cable Drive**

Cable drive wiper motor kit for Chev 1957

**NOTE: Customer Original Posts required for rework.**

**W/M-CHEV-1957 C/D**

---

## **Ford Mustang 1968 Replacement Cable Drive**

2 Speed self parking Cable drive wiper motor kit.

**W/M-MUSTANG C/D**

---

## **Ford Mustang 1969 Replacement Cable Drive**

2 Speed self parking Cable drive wiper motor kit.

**W/M-MUSTANG 69 C/D**

---

## **Ford Mustang 1969 Replacement Cable Drive**

2 Speed self parking Cable drive wiper motor kit.

includes Intermittent Speed control

**W/M-MUSTANG C/D INT**

---

## **Ford A-Model Cable Drive**

Cable drive wiper motor kit for Ford A-Model. Specify above or below screen when ordering

**W/M-FORD A-MODEL C/D**

---

## **Ford 1932-34 Cable Drive**

Cable drive wiper motor kit for Ford 1932-34. Suit Steel or Fibreglass bodies.  
Specify above or below screen when ordering

**W/M-FORD 1932-34 C/D**

---

## **Ford 1935-40 Cable Drive**

Cable drive wiper motor kit for Ford 1935-36-37-38-39-40. Suit Steel or Fibreglass bodies.  
Above or below windscreen mounting position

**W/M-FORD 1935-40 C/D**

---

## **Ford GT40 Kit Car Cable Drive**

Cable drive wiper motor kit for Ford GT40 kit cars. Single post configuration.  
Includes chrome bezels, arms and blades

**W/M-GT40 C/D**

---

## **Ford Zephyr Mk 2**

Replacement Wiper cable drive kit

**W/M-FORD ZEPHYR-C/D**

---



# WIPER MOTOR - CABLE DRIVE KITS

---

**Holden FX-FJ Cable Drive****W/M-HOLDEN FX-FJ C/D**

Cable drive wiper motor for Holden FX-FJ.

Includes Chrome bezel and 2 speed switch

---

**Holden HR Cable Drive****W/M-HOLDEN HR C/D**

Cable drive wiper motor kit for Holden HR. Need original posts to modify

Under dash mount position. Includes Arms and Blades

---

**Holden HK-HT-HG Cable Drive****W/M-HOLDEN HK-HT-HG C/D**

Cable drive wiper motor kit for Holden HK-HT-HG.

Under dash mount position. Includes Arms and Blades

---

**Holden HQ-WB Cable Drive.****W/M-HOLDEN HQ-WB C/D**

Cable drive wiper motor kit for Holden HQ-WB. Need original posts to modify

Under dash mount position.

---

**Holden Torana LH-LX-UC Cable Drive.****W/M-HOLDEN LH-LX C/D**

2 Speed Self Parking Cable drive wiper motor kit.

Under dash mount position.

---

**Replacement Lucas Cable Drive Kit****W/M-LUCAS REPLACEMENT**

Replacement cable drive wiper motor kit for original Lucas motor. Includes toggle switch & relay

Suits most English cars with 32 tooth Wheelboxes. Please specify Make & Model when ordering

---

**Cobra Kit Car Cable Drive 2 Post****W/M-COBRA C/D-2**

Cable drive 2 Post wiper kit with 2 speed, self parking. Complete with loom and Switch

Includes chrome bezels, arms and blades, tubing and mounting bracket

---

**Cobra Kit Car Cable Drive 3 Post****W/M-COBRA C/D-3**

Cable drive 3 Post wiper kit with 2 speed, self parking. Complete with loom and Switch

Includes chrome bezels, arms and blades, tubing and mounting bracket

---

**Universal Cable Drive****W/M-CABLE UNIVERSAL C/D**

Universal cable drive wiper motor kit. Includes two posts with chrome bezel, 2 Speed Self parking Switch, Loom,

and mount and mounting bracket kit

---

**Austin Healey replacement****W/M-AUSTIN HEALEY**

Cable drive replacement Motor , flexible Drive cable, 2 Speed Self parking Switch and Wiring Loom

---

**Morris Minor 850cc Replacement.  
suit Lo Lite & 1000cc****W/M-MORRIS MINOR KIT**

Cable drive replacement motor with flexible drive cable, 2 Speed Self parking Switch, Mounting bracket.

and(2) Wheel boxes

---

**Landrover 1979 replacement suits most English cars****W/M-LANDROVER C/D**

Cable drive replacement Motor , flexible Drive cable, 2 Speed Self parking Switch and Wiring Loom

---

**NOTE: 1955-56 Oldsmobile and Buicks can't be done as Cable Drive**

---

# WIPER MOTOR - ARM DRIVE KITS

---

**Chev Camaro Arm Drive 1967****W/M-CAMARO 67**

*Arm drive wiper kit. Customer to supply original crank and ball*

---

**Chev 1949-52 Arm Drive****W/M-CHEV-1949-1952**

*Arm drive wiper motor kit for Chev 1949-52. Connects to Original Arms and Posts*

---

**Chev 1953-54 Arm Drive****W/M-CHEV-1953-1954**

*Arm drive wiper motor kit for Chev 1953-54. Need original posts as change-over*

---

**Chev 1958 Arm Drive****W/M-CHEV-1958**

*Arm drive wiper motor kit for Chev 1958*

---

**Chev 1959 Arm Drive****W/M-CHEV-1959**

*Arm drive wiper motor kit for Chev 1959*

---

**Chev Camaro 1968-69 Arm Drive****W/M-CAMARO 68-69**

*Arm drive wiper motor kit for Chev Camaro 1968-69*

---

**Chev C10 Pickup****W/M-CHEV-C10**

*Replacement arm drive wiper motor kit to suit Chev C10 and C20 pickup*

# WIPER MOTOR - ARM DRIVE KITS

---

<b>Ford Customline &amp; Mainline</b>	<b>W/M-FORD CUSTOMLINE</b>
---------------------------------------	----------------------------

Replacement wiper motor for Ford Customline & Mainline 1952-59 12Volt Only

Connects to original Arms and Posts  
Note: will not fit with original 6V Radio

---

<b>Ford Fairlane 1959</b>	<b>W/M-FORD FAIRLANE</b>
---------------------------	--------------------------

Replacement wiper motor for Ford Fairlane 500 & Ranchwagon

---

<b>Ford Fairlane 1958 Victoria</b>	<b>W/M-FORD VICTORIA</b>
------------------------------------	--------------------------

Replacement wiper motor for Ford Fairlane and Victoria body

---

<b>Ford Falcon</b>	<b>W/M-FORD XR-XT-XW-XY</b>
--------------------	-----------------------------

Replacement wiper motor for Ford Falcon XR-XT-XW-XY

---

<b>Holden EH-EJ</b>	<b>W/M-HOLDEN EH-EJ</b>
---------------------	-------------------------

Replacement wiper motor for Holden EH-EJ

---

<b>Holden FC-FE-FB-EK</b>	<b>W/M-HOLDEN FC-FB-FE-EK</b>
---------------------------	-------------------------------

Replacement wiper motor for Holden FC-FE-FB-EK

---

<b>Holden HK-HT-HG</b>	<b>W/M-HOLDEN HK-HT-HG</b>
------------------------	----------------------------

Replacement wiper motor for Holden HK-HT-HG

---

<b>Holden HQ-WB</b>	<b>W/M-HOLDEN HQ-WB</b>
---------------------	-------------------------

Replacement wiper motor for Holden HQ-WB

---

<b>Holden Torana LC-LJ</b>	<b>W/M-HOLDEN LC-LJ</b>
----------------------------	-------------------------

Replacement wiper motor for Holden Torana LC-LJ

---

<b>Studebaker</b>	<b>W/M-STUDE</b>
-------------------	------------------

Replacement wiper motor for 1952 Studebaker

---

# Wiper Motor Accessories

---

## **Wiper Motor Accessories**

<i>Polished Stainless Steel Wiper Arms</i>	<b>TC203</b>
<i>Polished Stainless Steel Wiper Blades</i>	<b>TE103-10</b>
<i>Polished Stainless Steel Wiper Blades</i>	<b>TE103-12</b>
<b>Wiper Arms to suit Flat screen</b>	<b>TC204</b>
<b>Wiper Blades to suit Flat screen</b>	<b>TE101-12</b>
<i>Chrome Bezels</i>	<b>519988Z</b>
<i>Wheel Box. Supplied with Chrome Bezel 12"</i>	<b>72889</b>
<i>Intermittent rotary wiper switch. 2 speed</i>	<b>75600-02B</b>
<i>Replacement 2 speed rotary wiper switch</i>	<b>75228-03</b>
<i>Universal wiper washer bottle</i>	<b>50000</b>

# Dynogen

---

## **Key Benefits**

## **Alternator in a Generator**

**60 amp continuous rating (80 amp peak)**

**Built in regulator with concealed wiring.**

**Aluminium housing - Fraction of the original's weight**

**Charges from only 600RPM.**

**Designed and Engineered in Australia by CAE.**

**Only available in negative earth.**

---

**Lucas C39/C40**

**Dynogen - C40**

*Customer to provide original generator for conversion*

---

**Lucas C42**

**Dynogen - C42**

*Customer to provide original generator for conversion*

---

**Lucas C45**

**Dynogen - C45**

*Customer to provide original generator for conversion*

---

**Lucas N35**

**Dynogen - N35**

*Customer to provide original generator for conversion*

---

**Delco-Remy-12v P/n110230-2c13**

**Dynogen - D/Remy**

*Customer to provide original generator for conversion*

---

**Ford Side Valve**

**Dynogen - S/V-Early**

*Customer to provide original generator for conversion*

1144mm O. D. Body

---

**Ford Side Valve**

**Dynogen - S/V-Late**

*Customer to provide original generator for conversion*

122mm O. D. Body

---

# Alternators

---

## **BILLET ALTERNATORS**      **NEW in 2016**

### **CAE Performance Products Billet 220Amp Alternator**

suit Chev SB-BB-LS1 2 3 - Chrysler - Ford - Holden V8 - V6 and straight Six. Special applications catered for.

Chevrolet S/B and B/B V8 - Ford V8W and V8C - Holden V8 and inline 6Cyls	<b>ALT-BILLET-01</b>
Chevrolet - Commodore LS1-2-3	<b>ALT-BILLET-02</b>
Commodore Ecotec V6	<b>ALT-BILLET-03</b>
Chrysler V8s 318-360 and 383-440 also 245 Hemi 6Cyls	<b>ALT-BILLET-04</b>

Finish available in Machined Aluminium, Polished Aluminium and Black Anodized. Other colours available on request.

Special Applications Catered for.

---

## **REPLACEMENT GENERATORS**

Lucas C39 Generator with Tacho Drive rated at 20 AMP 12V Suits all applications	<b>GEN-140-300</b>
---	--------------------

---

## **CHROME ALTERNATORS**

Ford V8 & 6 Replacement - 55 Amp	<b>BXF1238C</b>
Holden - Chev - 55 Amp	<b>BXH1236C</b>
Holden - Chev - 85 Amp	<b>BXU1285C</b>
Holden - Chev- Ford - 120 Amp	<b>BXU12121C</b>
Nippon Denso Internal fan type - 80 Amp. Available in Vee belt or Serpentine pulley.	<b>AN-20511C</b>

---

## **REPLACEMENT ALTERNATORS**

Replacement 140 Amp Alternator for Chev/Holden GEN III.	<b>A-1306B</b>
Replacement 12v 140 Amp Alternator for GEN IV Replaces - Mitsubishi A003TG1582	<b>ALT-GENIV</b>
Nippon Denso Internal fan type - 80 Amp. Available in Vee belt or Serpentine pulley.	<b>AN-20511R</b>
Nippon Denso Internal fan type - 12V 60 Amp.	<b>AN-23361</b>
Ford V8 & 6 Replacement - 55 Amp	<b>BXF1238</b>
Holden - Chev - 55 Amp	<b>BXH1236</b>
Holden - Chev - 85 Amp	<b>BXU1285</b>
Holden - Chev - 85 Amp Counter Clockwise Rotation	<b>BXU1285-CCW</b>
Holden - Chev- Ford - 120 Amp	<b>BXU12121</b>

## **ENGLISH VEHICLES LUCAS**

Alternator replacement for original LUCAS on most English vehicles. 12V 70 AMP	<b>ANL-900</b>
--	----------------

---

## **ALTERNATOR BRACKETS**

### **SMALL BLOCK CHEV**

Low mount Chev small block suit Bosch & ND alternators - bare	<b>CAE-040</b>
Low mount Chev small block suit Bosch & ND alternators - chrome	<b>CAE-040C</b>
New Hi-Mount Alternator Bracket Suit Chev S/B short & long water pump.	<b>CAE-207</b>
Chev S/B Power Steering Mount	<b>CAE-208</b>
High mount LHS alternator bracket - short water pump.	<b>200L</b>
High mount LHS alternator bracket - short water pump.	<b>228L</b>
Side mount LHS alternator bracket - short water pump.	<b>213L</b>

### **BIG BLOCK CHEV**

Side mount LHS alternator bracket - short water pump.	<b>218L</b>
High mount LHS alternator bracket - long water pump.	<b>216L</b>
Low mount Chev big block- suit Bosch & ND alternators - bare	<b>CAE-053</b>
Low mount Chev big block- suit Bosch & ND alternators - chrome	<b>CAE-053C</b>
Side mount RHS A/C bracket - short water pump.	<b>118R</b>
High mount RHS A/C bracket - long water pump.	<b>116R</b>

---

Continued:

## ALTERNATOR BRACKETS

### FORD WINDSOR

FORD Windsor Billet Aluminium Alternator bracket with all adjustments.

MPP-30400

### FORD CLEVELAND

FORD Cleveland Billet Aluminium Alternator bracket with all adjustments.

MPP-30405

FORD Cleveland Billet Aluminium Power Steering Pump bracket with all adjustments.

MPP-30351

## ALTERNATOR PULLEYS

### CAE-PULLEYS - New Aluminium pulleys suit Chev - Polished

# Ignition Systems

## DISTRUBTORS

### CHEVROLET

CHEV V8 307-350-454 Small Block and Big Block

DIST-05

BOSCH Sequential Distributor

DIST-02

DELCO LATE HEI Distributor

DIST-03

CHEV V8 HEI 307-350-454 Small Block and Big Block With built-in coil

DIST-04

CHEV V8 307-350-454 Small Block and Big Block

DIST-05

CHEV LT-1 1995-96 T.P.I.

DIST-12

CHEV LT-1 1992-94

DIST-13

### CHRYSLER

CHRYSLER V8 273 - 318 - 360

DIST-14

CHRYSLER V8 383 - 440 ELEC DIST

DIST-15

CHRYSLER V8 273 - 318 - 360 Pro-Billet

DIST-24

### FORD

FORD V8 windsor HEI 260-289-302-351 with built-in coil

DIST-21

FORD V8 windsor HEI 351 with built-in coil Gear 31.36mm Oil pump shaft 13mm

DIST-22

FORD V8 Cleveland Late 302-351 Oil pump shaft 12.5mm

DIST-08

FORD V8 Cleveland Early V8 302-351-460 Gear 36.36mm Oil pump shaft 13mm

DIST-10

FORD V8 windsor 260-289-302 Gear 31.36mm Oil pump 11.5mm with built-in coil

DIST-09

FORD V8 windsor 289-302 Gear 31.36mm Oil pump shaft 13mm

DIST-11

FORD 6cyl EA-EB- CPI and MPI

DIST-23

FORD AW 311470

no TBA

FORD V8 windsor 289-302 Late EFI ENGINE

DIST-25

FORD V8 390-427 Electronic Distributor

DIST-16

FORD V8 Flathead suit 1949-53 Electronic Distributor Requires Ignition Control box PC2115

DIST-17

FORD V8 Flathead suit 1939-48 Electronic Distributor Requires Ignition Control box PC2115

DIST-18

### HOLDEN

#### HOLDEN DISTRIBUTORS

HOLDEN V8 253-304

DIST-07

HOLDEN V8 HEI 253-308 With built-in coil Not suitable for Commodores

DIST-06

HOLDEN V8 253-308 Pro-Billet

no TBA

HOLDEN V8 Commodore VN-VG-VP 5.0L Oval plug Blue

DIST-19

HOLDEN V8 Commodore VN-VG-VP 5.0L square plug Black

DIST-19A

HOLDEN V8 Commodore VT Series 1

DIST-20

### LEXUS

#### LEXUS DISTRIBUTORS

LEXUS V8 with GM cap and rotor suits Delco 808 ECM

DIST-01

## IGNITION ACCESSORIES

### MODULES

Ignition Module suit Holden Commodore V8 VN-VP-VR-VS-VT

37016

Ignition Control Box suit DIST-17 and DIST-18

PC2115

### COILS

COILS to suit most Electronic Distributor applications. (use with Dist-05-07-08-09-10-11)

BIC-290